

2020 Collectors Change, LRP data A/D These plans are computer generated. Users are prohibited from using or reproducing these plans without written permission from A/D.

GENERAL THE DESIGN PROFESSIONAL WHO PREPARED THESE DRAWINGS IS NOT RESPONSIBLE FOR THE MISUSE OF, OR UNAUTHORIZED CHANGES MADE TO THESE DRAWINGS. THE CONTRACTOR SHALL OBTAIN WRITTEN PERMISSION FROM THE DESIGN PROFESSIONAL WHO PREPARED THESE DRAWINGS PRIOR TO MAKING CHANGES.

THE CONTRACTOR SHALL: FURNISH AND INSTALL MATERIALS IN ACCORDANCE WITH THE STANDARD SPECIFICATIONS OF THE CITIES AND COUNTY OF MARIN DATED JUNE 1992, THE UNIFORM CONSTRUCTION STANDARDS OF THE CITIES AND COUNTY OF MARIN DATED MAY 2008, THE SAUSALITO-MARIN CITY SANITATION DISTRICT STANDARD SPECIFICATIONS AND DRAWINGS DATED 2007, THE MARIN MUNICIPAL WATER DISTRICT STANDARD DETAILS (CURRENT EDITION) AND STANDARD SPECIFICATIONS DATED MAY 2008.

OBTAIN RELEVANT PERMITS AND APPROVALS REQUIRED BY GOVERNING AGENCIES PRIOR TO COMMENCING WORK. ARRANGE A PRE-CONSTRUCTION MEETING WITH THE MARIN COUNTY DEPARTMENT OF PUBLIC WORKS 48 HOURS PRIOR TO COMMENCING GRADING WORK WITHIN THE PUBLIC RIGHT OF WAY.

VERIFY THAT THE OWNER HAS FILED A NOTICE OF INTENT WITH THE STATE WATER RESOURCES CONTROL BOARD PRIOR TO CONDUCTING CONSTRUCTION ACTIVITY.

ASSUME SOLE AND COMPLETE RESPONSIBILITY FOR JOB SITE CONDITIONS DURING THE COURSE OF CONSTRUCTION FOR THE PROJECT, INCLUDING SAFETY OF ALL PERSONS AND PROPERTY. THIS REQUIREMENT APPLIES CONTINUOUSLY, AND IS NOT LIMITED TO NORMAL WORKING HOURS.

HOLD HARMLESS, INDEMNIFY AND DEFEND THE OWNER, THE DESIGN PROFESSIONAL, THEIR CONSULTANTS AND THE COUNTY OF MARIN, FROM LIABILITY, REAL OR ALLEGED IN CONNECTION WITH THE PERFORMANCE OF WORK ON THIS PROJECT, EXCEPTING LIABILITY ARISING FROM THE WILLFUL MISCONDUCT OR SOLE NEGLIGENCE OF THE DESIGN PROFESSIONAL.

SUBMIT A TRAFFIC CONTROL PLAN TO THE DEPARTMENT OF PUBLIC WORKS AND OBTAIN APPROVAL PRIOR TO COMMENCING WORK IN THE PUBLIC RIGHT-OF-WAY.

PROVIDE A PROPERLY SIGNED ALTERNATE ACCESSIBLE ROUTE OF TRAVEL IF CONSTRUCTION ACTIVITIES IMPACT PEDESTRIAN ACCESS. THIS REQUIREMENT APPLIES CONTINUOUSLY, AND IS NOT LIMITED TO NORMAL WORKING HOURS.

CONTACT UNDERGROUND SERVICE ALERT (811) AT LEAST 48-HOURS BEFORE EXCAVATING.

PROPERLY MUFFLE EQUIPMENT AND LIMIT CONSTRUCTION HOURS TO 7:00 AM TO 6:00 PM MONDAY THROUGH FRIDAY, AND 9:00 AM TO 5:00 PM ON SATURDAY, EXCLUDING HOLIDAYS. THIS RESTRICTION INCLUDES THE STARTUP OF MOTOR VEHICLES AND OTHER HEAVY EQUIPMENT.

REPAIR DAMAGE TO FACILITIES OCCURRING AS A RESULT OF CONSTRUCTION ACTIVITIES TO RETURN THEM TO THEIR ORIGINAL CONDITION PRIOR TO CONSTRUCTION. THE CONTRACTOR DOES NOT ACT PRUDENTLY, THE COUNTY OF MARIN MAY, AT ITS DISCRETION PERFORM THE CORRECTION AND CHARGE THE CONTRACTOR FOR COSTS INCURRED.

WHERE UNDERCUT SUBGRADE OR UNSUITABLE SUBGRADE MATERIAL IS ENCOUNTERED, THE AGENCY ENGINEER MAY REQUIRE REMEDIAL WORK TO BE DONE, INCLUDING OVER-EXCAVATION AND BACKFILLING WITH CRUSHED ROCK AND WHEN DIRECTED BY THE ENGINEER, PLACING GEOTEXTILE FABRIC BENEATH THE NEW CONCRETE SECTION.

GRADING PROVIDE PROTECTIVE FENCE AROUND THE DRIP LINES OF TREES WHICH WILL REMAIN FOLLOWING CONSTRUCTION PRIOR TO PERFORMING GRADING OPERATIONS. RETAIN THE SERVICES OF A COUNTY APPROVED ARBORIST PRIOR TO DISTURBING EARTH WITHIN THE ROOT ZONES OF TREES WHICH WILL REMAIN FOLLOWING CONSTRUCTION. PERFORM CONSTRUCTION IN THE ROOT ZONES OF TREES UNDER THE OBSERVATION OF THE PROJECT ARBORIST.

PERFORM GRADING IN ACCORDANCE WITH CHAPTER 18 AND APPENDIX J OF THE CALIFORNIA BUILDING CODE (THE VERSION IN EFFECT AS ADOPTED BY COUNTY ORDINANCE AT THE TIME OF PERMIT ISSUANCE), UNDER THE OBSERVATION OF THE GEOTECHNICAL ENGINEER AND IN ACCORDANCE WITH THE RECOMMENDATIONS OF THE GEOTECHNICAL REPORT, PREPARED BY KRAZAN & ASSOCIATES, INC. GEOTECHNICAL ENGINEERING DIVISION DATED OCTOBER 30, 2020.

PERFORM GRADING TO WITHIN 0.10- FEET OF THE LINES AND ELEVATIONS SHOWN ON THE CONSTRUCTION DRAWINGS.

PROVIDE A MOISTURE BARRIER IN AREAS WHERE CURB AND GUTTER ARE ADJACENT TO LANDSCAPING AND WHERE THE SOIL EXPANSION INDEX IS GREATER THAN 51.

REMOVE MATERIAL WHICH WILL NOT BE USED ON SITE AS IT IS EXCAVATED AND DISPOSE OF IN ACCORDANCE WITH THE GOVERNING AGENCY'S REQUIREMENTS.

MAINTAIN A CLEAN CONSTRUCTION SITE TO PREVENT THE INTRODUCTION OF FOREIGN MATERIALS INTO THE STORM WATER CONVEYANCE SYSTEM ACTIVITY DURING CONSTRUCTION WHICH RESULTS IN THE DISCHARGE OF POLLUTANTS TO THE STORM WATER CONVEYANCE SYSTEM IS IN VIOLATION OF THE MARIN COUNTY CODE OF ORDINANCES AND THE SAN FRANCISCO BAY REGIONAL WATER QUALITY CONTROL BOARD'S REGULATIONS.

PROVIDE DUST CONTROL THROUGHOUT THE DURATION OF THE CONSTRUCTION PROJECT TO MINIMIZE AIRBORNE POLLUTANTS.

STOP WORK IF CONTAMINATED MATERIAL IS ENCOUNTERED. PREPARE A WORK PLAN AND ACQUIRE APPROVAL IN WRITING FROM THE MARIN CITY FIRE DEPARTMENT AND THE SAN FRANCISCO BAY REGIONAL WATER QUALITY CONTROL BOARD PRIOR TO RESUMING WORK.

STOP WORK AND NOTIFY THE OWNER'S REPRESENTATIVE AND THE MARIN COUNTY LIAISON IF REMAINS OF PREHISTORIC OR HISTORIC HUMAN ACTIVITIES ARE ENCOUNTERED. CONTACT THE MARIN COUNTY CORONER IF HUMAN REMAINS ARE ENCOUNTERED. THE OWNER WILL RETAIN THE SERVICES OF A QUALIFIED ARCHAEOLOGIST APPROVED BY MARIN COUNTY TO EVALUATE THE SITUATION AND MAKE RECOMMENDATIONS FOR TREATMENT OF THE RESOURCE. THE CONTRACTOR SHALL PROCEED WITH WORK AT THE OWNER'S DIRECTION IN ACCORDANCE WITH THE RECOMMENDATIONS OF THE ARCHAEOLOGIST.

THE CALIFORNIA BUILDING CODE REQUIRES THAT MATERIALS USED FOR THE CONSTRUCTION OF PERMANENT STRUCTURES LOCATED NEARER THAN 6 INCHES TO EARTH BE TREATED, OR OF NATURAL RESISTANCE TO DECAY. ELEVATIONS HAVE BEEN ESTABLISHED WITH THIS SET OF CIVIL DRAWINGS, WHICH MAY REQUIRE THE IMPLEMENTATION OF A RAISED CURB ALONG THE PERIMETER OF THE BUILDING WHERE ADJACENT TO LANDSCAPE AREAS. THE CONTRACTOR SHALL COORDINATE THE LOCATION(S) OF RAISED CURBS PRIOR TO POURING THE CONCRETE SLAB.

THE CONTRACTOR SHALL NOT IMPEDE DRAINAGE FROM EXISTING UPSTREAM PROPERTIES. THE CONTRACTOR SHALL PLACE STOCKPILES AWAY FROM DRAINAGE SETBACKS, AWAY FROM VEGETATION DESIGNATED TO REMAIN, A MINIMUM OF 10- FEET FROM ADJACENT EXISTING RESIDENTIAL PARCELS, AND A MINIMUM OF 50- FEET FROM ADJACENT EXISTING RESIDENTIAL PARCELS WHERE THE STOCK PILE DEPTH EXCEEDS 2.5- FEET.

A PROTECTION ZONE SHALL BE ESTABLISHED TO PROTECT NATURAL VEGETATION AND TREES (WHICH WILL REMAIN FOLLOWING CONSTRUCTION) FROM CONSTRUCTION ACTIVITIES. THE FOLLOWING CONDITIONS AND RESTRICTIONS SHALL APPLY: I. THE ZONE SHALL ENCOMPASS THE "PROTECTED PERIMETER" WHICH SHALL BE EITHER THE ROOT ZONE OR OTHER LIMIT AS ESTABLISHED IN THIS APPROVAL. II. THE ZONE SHALL BE DELINEATED WITH A BRIGHTLY COLORED CONSTRUCTION FENCE. SUCH FENCES SHALL REMAIN CONTINUOUSLY IN PLACE FOR THE DURATION OF ALL WORK UNDERTAKEN ON THE SITE. III. NO STORAGE OR CONSTRUCTION ACTIVITIES (INCLUDING TRENCHING, GRADING OR FILLING) SHALL BE PERMITTED WITHIN THE PROTECTED ZONE. IV. NO BURNING OR USE OF EQUIPMENT WITH AN OPEN FLAME SHALL OCCUR NEAR OR WITHIN THE PROTECTED PERIMETER. V. BRUSH, EARTH AND OTHER DEBRIS SHALL BE REMOVED IN A MANNER WHICH PREVENTS INJURY TO THE PROTECTED TREES AND/OR SHRUBS. VI. NO OIL, GAS, CHEMICALS OR OTHER SUBSTANCES THAT MAY BE HARMFUL TO TREES SHALL BE STORED OR DUMPED WITHIN THE PROTECTED PERIMETER OR ANY OTHER LOCATION FROM WHICH SUBSTANCES MIGHT ENTER THE PERIMETER OF A PROTECTED TREE.

THE PROTECTION ZONE DELINEATED WITH THE BRIGHTLY COLORED CONSTRUCTION FENCE SHALL BE POSTED WITH SIGNS WHICH STATE "TREE/VEGETATION PROTECTION ZONE- NO CONSTRUCTION PERMITTED." ANY SPECIAL WORK, INCLUDING MITIGATION, WITHIN THE "PROTECTION ZONE" MUST BE DONE UNDER THE SUPERVISION OF A COUNTY APPROVED CERTIFIED ARBORIST.

EARTHWORK QUANTITIES ARE APPROXIMATE AND HAVE BEEN SUMMARIZED ON THESE DRAWINGS TO PROVIDE THE REVIEWING AGENCY WITH AN OPINION OF HOW MUCH MATERIAL MAY BE MOVED TO FACILITATE THE PROPOSED IMPROVEMENTS. WHILE THE DESIGN PROFESSIONAL ANTICIPATES THAT AS MUCH AS 4,500 CY MAY BE EXPORTED WITH THIS PROJECT, ACTUAL VOLUMES ARE VARIABLE BASED ON THE GEOTECHNICAL ENGINEER'S ASSESSMENT OF THE SOIL ENCOUNTERED, THE CONTRACTOR'S METHOD OF STRIPPING, COMPACTION AND TRENCHING.

OPINION OF PROBABLE EARTHWORK QUANTITIES. TABLE with columns: MATERIAL MOVED ON SITE*, IMPORT, EXPORT and values: 2,500 CY, NOT ANTICIPATED, 4,500 CY.

*MATERIAL MOVED ON SITE IS SOIL EXCAVATED (CUT) AS A RESULT OF STRIPPING OR GRADING ACTIVITIES AND REUSED ON THE PROJECT SITE AS FILL.

PUBLIC CONCRETE

EXISTING CONCRETE SHALL BE REMOVED AT EXPANSION OR WEAKENED PLANE JOINTS OR AT SAWCUTS AS FIELD MARKED BY THE AGENCY ENGINEER. SAW CUTS MUST GO ENTIRELY THROUGH THE CONCRETE.

FOR NEW DEVELOPMENT, NO UTILITY BOXES OR POLES WILL BE PERMITTED IN THE SIDEWALK AREA WITHOUT THE PRIOR WRITTEN APPROVAL OF THE AGENCY ENGINEER.

WHERE UNDERCUT SUBGRADE OR UNSUITABLE SUBGRADE MATERIAL IS ENCOUNTERED, THE AGENCY ENGINEER MAY REQUIRE REMEDIAL WORK TO BE DONE, INCLUDING OVER-EXCAVATION AND BACKFILLING WITH CRUSHED ROCK AND WHEN DIRECTED BY THE ENGINEER, PLACING GEOTEXTILE FABRIC BENEATH THE NEW CONCRETE SECTION.

SUBGRADE SHALL BE COMPACTED TO AT LEAST 95-PERCENT RELATIVE COMPACTION IN THE TOP 6-INCHES.

NEW WORK SHALL MATCH EXISTING AS CLOSELY AS POSSIBLE IN FINISH, SCORING AND COLOR. FOR NEW INSTALLATIONS, PLACE ADJACENT TO EXISTING, 2- POUND DAVIS BLOCK #8084 (OR EQUIVALENT) PER CUBIC YARD OF CONCRETE SHALL BE ADDED TO THE MIX.

EXCEPT WHERE SPECIFIED OTHERWISE HEREIN, NO ADMIXTURES SHALL BE USED WITHOUT THE PERMISSION OF THE AGENCY ENGINEER.

FORMS SHALL MEET GRADE AND FORM FACES SHALL NOT VARY FROM THE DIMENSIONS SHOWN BY MORE THAN 1/2-INCH.

NO CONCRETE SHALL BE PLACED UNTIL THE AGENCY ENGINEER HAS INSPECTED AND APPROVED FORMS AND SUBGRADE/BASE.

SUBGRADE/BASE SHALL BE THOROUGHLY WETTED IMMEDIATELY PRIOR TO PLACING CONCRETE.

CONCRETE SHALL BE A MINIMUM CLASS B (5-SACK MIX) WITH 1-INCH MAXIMUM AGGREGATE FROM AN APPROVED MIXING PLANT. NO BAGGED MIX IS PERMITTED.

CONCRETE SHALL HAVE A SLUMP OF NOT MORE THAN 4-INCHES.

FOR SIDEWALKS AND DRIVEWAY APPROACHES, 1/4-INCH DEEP SCORE LINES SHALL BE PLACED AT 4- FEET ON CENTER OR AS DIRECTED BY THE AGENCY ENGINEER.

WEAKENED PLANE JOINTS AT LEAST 3/4-INCH DEEP SHALL BE PLACED AT A MAXIMUM OF 18- FEET ON CENTER EXCEPT FOR SIDEWALKS AND DRIVEWAY APPROACHES WHICH SHALL BE AT A MAXIMUM OF 5- FEET ON CENTER.

3/8-INCH THICK EXPANSION JOINTS SHALL BE PLACED ON BOTH SIDES OF DRIVEWAY APPROACHES, AT CURB AND SIDEWALK RETURN POINTS, DRAINAGE STRUCTURES AND OTHER LOCATIONS AS SHOWN ON THE CONSTRUCTION DOCUMENTS.

EXPOSED EDGES SHALL BE ROUNDED WITH A 1/2-INCH RADIUS TOOL.

FLAT SURFACES SHALL BE LIGHT BROOM FINISHED UNLESS OTHERWISE SPECIFIED BY THE AGENCY ENGINEER.

CURBS, SIDEWALKS AND DRIVEWAY APPROACHES SHALL HAVE FORMS REMOVED AND BE BACKFILLED WITHIN SEVEN DAYS AFTER POURING.

THE DESIGNATED DIMENSIONS AND SLOPES MAY BE MODIFIED TO ACCOMMODATE EXISTING ADJACENT FACILITIES SUBJECT TO THE APPROVAL OF THE AGENCY ENGINEER.

UTILITIES

THE CONTRACTOR SHALL: SEARCH FOR EXISTING WELLS AND SEPTIC SYSTEMS WITH THE PROJECT GEOTECHNICAL ENGINEER PRIOR TO CONDUCTING CONSTRUCTION ACTIVITY.

ABANDON EXISTING SEPTIC SYSTEMS UNDER THE OBSERVATION OF THE PROJECT GEOTECHNICAL ENGINEER AS REQUIRED BY MARIN COUNTY.

ABANDON EXISTING WELLS IN ACCORDANCE WITH MARIN COUNTY REGULATIONS.

MAINTAIN ACCESS TO EXISTING UTILITIES OUTSIDE OF THE LIMIT OF WORK FOR THE DURATION OF CONSTRUCTION ACTIVITIES.

EXPONE EXISTING UTILITIES PRIOR TO TRENCHING TO VERIFY THE ALIGNMENTS AND ELEVATIONS OF THE UTILITIES, AND TO VERIFY DESIGN ASSUMPTIONS. EXISTING UTILITIES MAY REQUIRE RELOCATION AND/OR PROPOSED IMPROVEMENTS MAY REQUIRE GRADE OR ALIGNMENT REVISION DUE TO FIELD CONDITIONS. IF THE EXPOSED UTILITY IS DETERMINED TO BE IN A LOCATION WHICH IS NOT REFLECTED BY THE CONSTRUCTION DOCUMENTS, NOTIFY THE ENGINEER IN WRITING SO THAT APPROPRIATE ADJUSTMENTS CAN BE MADE.

REPORT UTILITY CONFLICTS TO THE OWNER'S REPRESENTATIVE IN WRITING AS THEY ARE ENCOUNTERED SO THAT THE OWNER AND OWNER'S REPRESENTATIVE CAN MAKE A DECISION AS TO HOW THE CONTRACTOR SHOULD PROCEED WITH THE WORK.

UNLESS OTHERWISE NOTED, PROVIDE CLASS III REINFORCED CONCRETE PIPE (RCP), OR HIGH DENSITY POLYETHYLENE PIPE (HDPE) WHERE ANNOTATED AS STORM DRAIN (SD) ON THE CONSTRUCTION DRAWINGS.

PROVIDE TRENCHING FOR SANITARY SEWER UTILITIES IN ACCORDANCE WITH SAUSALITO-MARIN CITY SANITATION DISTRICT STANDARD SPECIFICATIONS AND DRAWINGS STANDARD DRAWING SD-4 AND FOR OTHER UTILITIES IN ACCORDANCE WITH THE UNIFORM CONSTRUCTION STANDARDS OF THE CITIES AND COUNTY OF MARIN DRAWING NUMBERS 330, 340 AND 350.

COORDINATE WITH UTILITY COMPANIES, FURNISH, INSTALL, TEST AND OBTAIN INSPECTIONS FOR UNDERGROUND IMPROVEMENTS PRIOR TO SURFACING.

OTHER FORCES WILL BE ENGAGED IN INSTALLING, IN MAKING ADJUSTMENTS TO AND/OR IN RELOCATING VARIOUS FACILITIES THROUGHOUT THE PROJECT. THE CONTRACTOR SHALL COORDINATE THESE FACILITIES OR FOR IN A MANNER THAT DOES NOT PROLONG THE CONTRACT TIME.

EXISTING UNDERGROUND FACILITIES SHOWN ON THESE DRAWINGS ARE APPROXIMATE AND HAVE BEEN LOCATED BASED ON TOPOGRAPHIC FEATURES AND AVAILABLE INFORMATION. THE PROFESSIONAL WHO PREPARED THESE DRAWINGS, THE OWNER, AND COUNTY OF MARIN ASSUME NO RESPONSIBILITY FOR THE ACCURACY OF THESE FACILITIES OR FOR THE INADVERTENT OMISSION OF RELATED INFORMATION.

THE CONTRACTOR IS CAUTIONED NOT TO ORDER PRECAST ITEMS OR INSTALL IMPROVEMENTS UNTIL CONFLICTS ARE RESOLVED. IMPROVEMENTS INSTALLED OR ORDERED PRIOR TO CONFLICT RESOLUTION SHALL BE DONE SOLELY AT THE CONTRACTOR'S RISK AND AT NO EXPENSE TO THE OWNER, THE DESIGN PROFESSIONAL, OR THE COUNTY OF MARIN.

UTILITY CONFLICTS MAY OCCUR IN THOSE INSTANCES WHERE TWO GRAVITY UTILITIES CROSS AND LACK THE REQUIRED SEPARATION, OR IN THOSE INSTANCES WHERE AN EXISTING UTILITY HAS NOT BEEN IDENTIFIED IN THE CONSTRUCTION DOCUMENTS.

CROSSING UTILITIES WHICH HAVE BEEN IDENTIFIED IN THE CONSTRUCTION DOCUMENTS MAY NOT BE CONSTRUCTED AS UTILITY CONFLICTS. THE CONTRACTOR SHALL INSTALL GRAVITY UTILITIES ABOVE THE LINES AND ELEVATIONS IDENTIFIED IN THE CONSTRUCTION DOCUMENTS AND INSTALL OTHER UTILITIES ABOVE OR BELOW GRAVITY UTILITIES WHILE COMPLYING WITH THE MINIMUM COVER REQUIREMENTS FOR EACH UTILITY INSTALLED.

UTILITY LENGTHS SHOWN REFLECT ROUNDED LENGTHS MEASURED HORIZONTALLY BETWEEN THE CENTERS OF STRUCTURES. THE CONTRACTOR SHALL VERIFY SLOPED UTILITY LENGTHS IN THE FIELD PRIOR TO ORDERING MATERIAL.

THE CONTRACTOR SHALL NOTIFY THE SANITARY DISTRICT INSPECTOR AT (415) 331-4714, 48-HOURS PRIOR TO STARTING SEWER WORK. THE CONTRACTOR SHALL CONTACT THE SAUSALITO-MARIN CITY SANITATION DISTRICT FOR FINAL INSPECTION OF ALL SEWER MAINS AND LATERALS. ALL SEWER MAINS AND LATERALS MUST BE CLEANED & MANHOLE PRIOR TO ACCEPTANCE.

UNLESS OTHERWISE NOTED, THE CONTRACTOR SHALL PROVIDE DUCTILE IRON PIPE OR SDR26 POLYVINYL CHLORIDE PIPE (PVC) WHERE ANNOTATED AS SANITARY SEWER (SS) ON THE CONSTRUCTION DRAWINGS.

STRIPING AND SIGNING

STRIPING, PAVEMENT MARKINGS AND SIGNING SHALL BE INSTALLED IN ACCORDANCE WITH THE CURRENT EDITION OF THE CALIFORNIA MANUAL ON UNIFORM TRAFFIC CONTROL DEVICES (MUTCD).

PARKING STALLS SHOWN ON THESE DRAWINGS THAT ARE DEMARCATED WITH A 'C' ARE TO BE COMPACT PARKING SPACES AND SHALL INCORPORATE STRIPING INDICATING THEM AS SUCH IN ACCORDANCE WITH LOCAL REGULATIONS.

MAPPING

THE CONTRACTOR SHALL:

- PRESERVE AND PERPETUATE EXISTING SURVEY MONUMENTATION WHICH WILL BE DISTURBED OR REMOVED TO FACILITATE THE PROPOSED IMPROVEMENTS. IF WORK WILL BE CONDUCTED IN AN AREA WHICH RESULTS IN THE DISTURBANCE OF MONUMENTATION, RETAIN THE SERVICES OF A LICENSED LAND SURVEYOR TO LOCATE SAID MONUMENTATION PRIOR TO DISTURBANCE. ADDITIONALLY, RETAIN THE SERVICES OF A LICENSED LAND SURVEYOR TO RE-ESTABLISH MONUMENTATION WHICH HAS BEEN DISTURBED AS A RESULT OF PROJECT CONSTRUCTION AND TO FILE THE APPROPRIATE DOCUMENTATION, PURSUANT TO BUSINESS AND PROFESSIONS CODE SECTION 8771, WITH THE MARIN COUNTY RECORDER ONCE CONSTRUCTION IS COMPLETE.

TOPOGRAPHIC INFORMATION SHOWN HEREON WAS MAPPED BY KISTER, SAVIA & REI, INC. DATED APRIL 1, 2020.

TREE TRUNK DIAMETERS ARE REFLECTED GRAPHICALLY AND WERE MEASURED AT CHEST HEIGHT (48-INCHES). DRIPLENE DIAMETERS AND TREE SPECIES ARE APPROXIMATE ONLY. CONSULT A CERTIFIED TREE ARBORIST WHEN IT IS NECESSARY TO ACCURATELY DETERMINE PERTINENT TREE INFORMATION.

MISCELLANEOUS BOUNDARY INFORMATION SHOWN HEREON WAS OBTAINED FROM RECON DATA COLLECTED BY KISTER, SAVIA & REI, INC. AND DOES NOT CONSTITUTE A FORMAL BOUNDARY DETERMINATION.

BENCHMARK: NORTH AMERICAN VERTICAL DATUM OF 1988 (NAVD88), ESTABLISH BY AN RTK GPS SURVEY, REFERENCED TO THE TOPNET LIVE REAL TIME GNSS REFERENCE NETWORK.

BASIS OF BEARINGS: THE CALCULATED BEARING N70°20'44" BETWEEN TWO FOUND MONUMENTS ON DRAKE AVENUE AS SHOWN ON THE MAP OF MARIN CITY REDEVELOPMENT PROJECT UNIT FOUR, FILED OCTOBER 10, 1962, IN VOLUME 11 OF MAPS AT PAGE 46, RECORDS, MARIN COUNTY CALIFORNIA.

SYMBOLS & LEGEND

SYMBOLS & LEGEND. Table with columns: EXISTING, PROPOSED. Lists symbols for IRON PIPE, CONTROL POINT, CENTRAL LINE MONUMENT, BLOW OFF, GATE VALVE, CHECK VALVE, BACKFLOW PREVENTION DEVICE, FIRE DEPARTMENT CONNECTION, FIRE HYDRANT, POST INDICATOR VALVE, RISER, LIGHT POLE, STREET SIGN, UTILITY POLE, GUY ANCHOR, CATCH BASIN, DROP INLET, MANHOLE, CLEANOUT, TREE, TREE TO BE REMOVED, PROPERTY LINE, BUILDING SETBACK, EASEMENT, CENTERLINE, GRADE BREAK, FLOW LINE, FENCE, TREE PROTECTION FENCE, RETAINING WALL, SHORING WALL, FACE OF CURB, SANITARY SEWER, STORM DRAIN, WATER, OVERHEAD UTILITY LINE, UNDERGROUND UTILITY LINE, UNDERGROUND ELECTRIC LINE, UNDERGROUND GAS LINE, UNDERGROUND TELEPHONE LINE, ASPHALT, GRIND AND OVERLAY, LIGHT-WEIGHT CONCRETE, HEAVY-WEIGHT CONCRETE, VALLEY GUTTER, INVERT AT CLEANOUT, KEYNOTE, DETAIL IDENTIFICATION SHEET WHERE DETAIL IS SHOWN, CROSS SECTION IDENTIFICATION SHEET WHERE CROSS SECTION IS SHOWN, ABBREVIATIONS (MB, MH, MN, MON, NTS, OR, PAD, PCC, PSSE, PIV, PL, PTO, PUE, PVI, PVT, R, RE, RSPR, RTWL, R/W, RWL, S, SD, SDOO, SDMH, SF, SL, SS, SSCO, SSMH, STA, STD, TB, TC, TEL, TW, TYP, UB, UP, UT, VC, VERT, WL, WM, WS, YD).

MATERIALS TABLE

MATERIALS TABLE. Table with columns: SURFACE TYPE, LOCATION, THICKNESS, CL2 BASE ROCK, SAND, NOTE. Rows include PEDESTRIAN LIGHT-WEIGHT CONCRETE, VEHICULAR LIGHT-WEIGHT CONCRETE, VEHICULAR HEAVY-WEIGHT CONCRETE, PUBLIC CONCRETE, ASPHALT CONCRETE.

- 1. PROVIDE NUMBER 3 BARS AT 18-INCH ON CENTER AND EXPANSION JOINTS IN ACCORDANCE WITH THE GEOTECHNICAL RECOMMENDATIONS. CONCRETE TO HAVE A BROOMED FINISH. 2. PROVIDE EXPANSION JOINTS IN ACCORDANCE WITH THE GEOTECHNICAL RECOMMENDATIONS. CONCRETE TO HAVE A BROOMED FINISH. 3. PROVIDE A VAPOR RETARDER BETWEEN THE BASE ROCK AND SAND LAYER IN ACCORDANCE WITH THE GEOTECHNICAL RECOMMENDATIONS. 4. PROVIDE SUBGRADE PREPARATION IN ACCORDANCE WITH THE GEOTECHNICAL RECOMMENDATIONS. 5. WORK WITHIN PUBLIC RIGHT OF WAY TO BE IN ACCORDANCE WITH COUNTY OF MARIN UNIFORM CONSTRUCTION STANDARDS.

NOTES THE CONTRACTOR IS REQUIRED TO REVIEW THE PROJECT GEOTECHNICAL REPORT PREPARED BY KRAZAN & ASSOCIATES, INC., GEOTECHNICAL ENGINEERING DIVISION DATED OCTOBER 30, 2020 TO CONFIRM THESE CONDITIONS AND TO REVIEW SAID REPORT FOR SITE PREPARATION AND GRADING RECOMMENDATIONS.



DRAKE MARIN CITY APTS 825 DRAKE AVENUE COUNTY OF MARIN, CA 94065

PROJECT INFORMATION SHEET

SUBMITTAL - 07/10/2024 Project Number: 2020-074 Plan Check Number: 2

Table with columns: Revision Number, Description, Date. Rows include ASI #01, ASI #02, and several empty rows.

SHEET

3/15/2021 10:47:19 AM
SHEET NUMBER

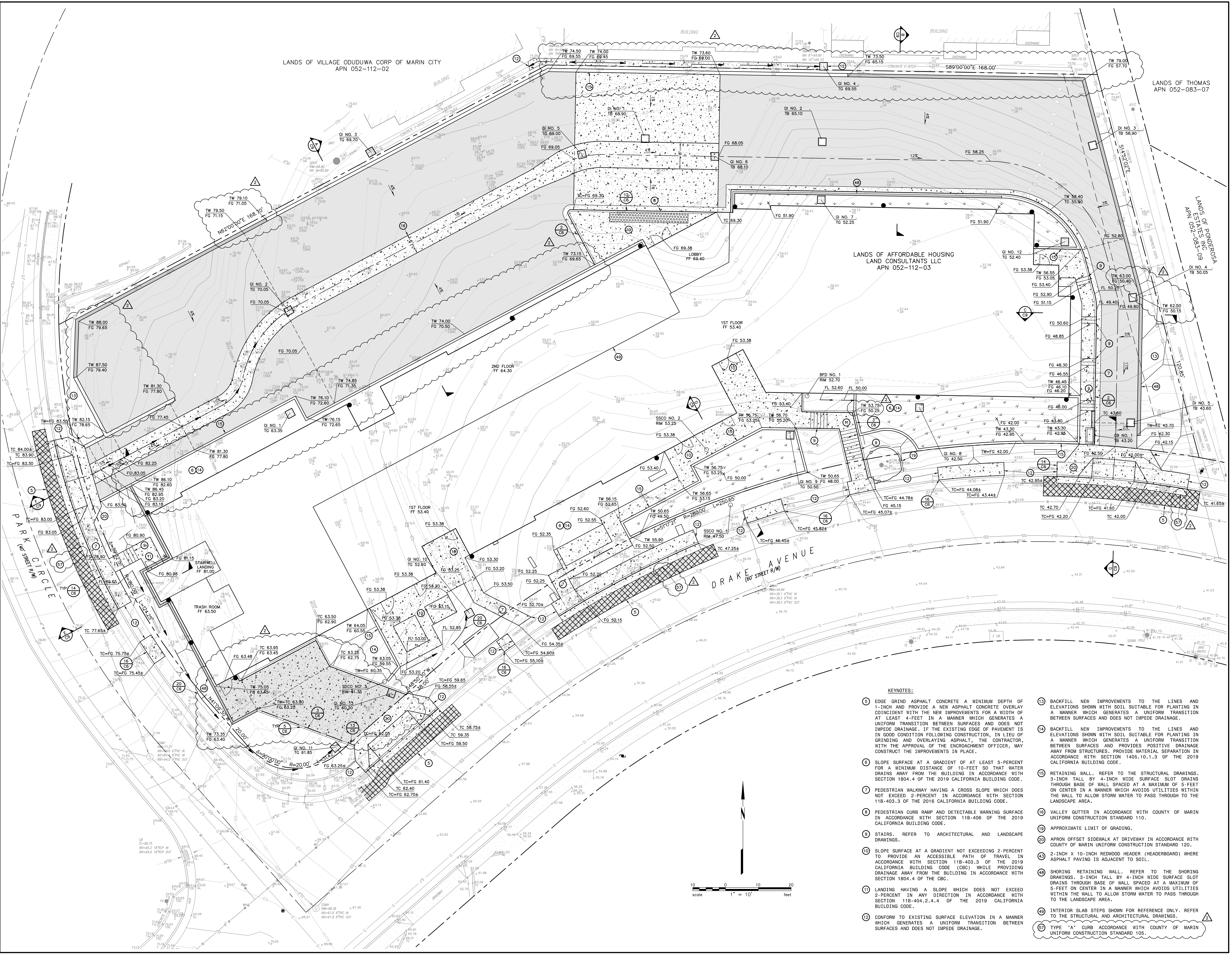

- KEYNOTES:**
- 5 EDGE GRIND ASPHALT CONCRETE A MINIMUM DEPTH OF 1-INCH AND PROVIDE A NEW ASPHALT CONCRETE OVERLAY COINCIDENT WITH THE NEW IMPROVEMENTS FOR A WIDTH OF AT LEAST 4- FEET IN A MANNER WHICH GENERATES A UNIFORM TRANSITION BETWEEN SURFACES AND DOES NOT IMPEDE DRAINAGE. IF THE EXISTING EDGE OF PAVEMENT IS IN GOOD CONDITION FOLLOWING CONSTRUCTION, IN LIEU OF GRINDING AND OVERLAYING ASPHALT, THE CONTRACTOR, WITH THE APPROVAL OF THE ENFORCEMENT OFFICER, MAY CONSTRUCT THE IMPROVEMENTS IN PLACE.
 - 6 SLOPE SURFACE AT A GRADIENT OF AT LEAST 5-PERCENT FOR A MINIMUM DISTANCE OF 10- FEET SO THAT WATER DRAINS AWAY FROM THE BUILDING IN ACCORDANCE WITH SECTION 1804.4 OF THE 2019 CALIFORNIA BUILDING CODE.
 - 7 PEDESTRIAN WALKWAY HAVING A CROSS SLOPE WHICH DOES NOT EXCEED 2-PERCENT IN ACCORDANCE WITH SECTION 11B-403.3 OF THE 2016 CALIFORNIA BUILDING CODE.
 - 8 PEDESTRIAN CURB RAMP AND DETECTABLE WARNING SURFACE IN ACCORDANCE WITH SECTION 11B-406 OF THE 2019 CALIFORNIA BUILDING CODE.
 - 9 STAIRS. REFER TO ARCHITECTURAL AND LANDSCAPE DRAWINGS.
 - 10 SLOPE SURFACE AT A GRADIENT NOT EXCEEDING 2-PERCENT TO PROVIDE AN ACCESSIBLE PATH OF TRAVEL IN ACCORDANCE WITH SECTION 11B-403.3 OF THE 2019 CALIFORNIA BUILDING CODE (CBC) WHILE PROVIDING DRAINAGE AWAY FROM THE BUILDING IN ACCORDANCE WITH SECTION 1804.4 OF THE CBC.
 - 11 LANDING HAVING A SLOPE WHICH DOES NOT EXCEED 2-PERCENT IN ANY DIRECTION IN ACCORDANCE WITH SECTION 11B-404.2.4.4 OF THE 2019 CALIFORNIA BUILDING CODE.
 - 12 CONFORM TO EXISTING SURFACE ELEVATION IN A MANNER WHICH GENERATES A UNIFORM TRANSITION BETWEEN SURFACES AND DOES NOT IMPEDE DRAINAGE.
 - 13 BACKFILL NEW IMPROVEMENTS TO THE LINES AND ELEVATIONS SHOWN WITH SOIL SUITABLE FOR PLANTING IN A MANNER WHICH GENERATES A UNIFORM TRANSITION BETWEEN SURFACES AND DOES NOT IMPEDE DRAINAGE.
 - 14 BACKFILL NEW IMPROVEMENTS TO THE LINES AND ELEVATIONS SHOWN WITH SOIL SUITABLE FOR PLANTING IN A MANNER WHICH GENERATES A UNIFORM TRANSITION BETWEEN SURFACES AND PROVIDES POSITIVE DRAINAGE AWAY FROM STRUCTURES. PROVIDE MATERIAL SEPARATION IN ACCORDANCE WITH SECTION 1405.10.1.3 OF THE 2019 CALIFORNIA BUILDING CODE.
 - 15 RETAINING WALL. REFER TO THE STRUCTURAL DRAWINGS. 3-INCH TALL BY 4-INCH WIDE SURFACE SLOT DRAINS THROUGH BASE OF WALL SPACED AT A MAXIMUM OF 5- FEET ON CENTER IN A MANNER WHICH AVOIDS UTILITIES WITHIN THE WALL TO ALLOW STORM WATER TO PASS THROUGH TO THE LANDSCAPE AREA.
 - 16 VALLEY GUTTER IN ACCORDANCE WITH COUNTY OF MARIN UNIFORM CONSTRUCTION STANDARD 110.
 - 19 APPROXIMATE LIMIT OF GRADING.
 - 20 APRON OFFSET SIDEWALK AT DRIVEWAY IN ACCORDANCE WITH COUNTY OF MARIN UNIFORM CONSTRUCTION STANDARD 120.
 - 2-INCH X 10-INCH REDWOOD HEADER (HEADERBOARD) WHERE ASPHALT PAVING IS ADJACENT TO SOIL.
 - 48 SHORING RETAINING WALL. REFER TO THE SHORING DRAWINGS. 3-INCH TALL BY 4-INCH WIDE SURFACE SLOT DRAINS THROUGH BASE OF WALL SPACED AT A MAXIMUM OF 5- FEET ON CENTER IN A MANNER WHICH AVOIDS UTILITIES WITHIN THE WALL TO ALLOW STORM WATER TO PASS THROUGH TO THE LANDSCAPE AREA.
 - 49 INTERIOR SLAB STEPS SHOWN FOR REFERENCE ONLY. REFER TO THE STRUCTURAL AND ARCHITECTURAL DRAWINGS.
 - 57 TYPE "A" CURB ACCORDANCE WITH COUNTY OF MARIN UNIFORM CONSTRUCTION STANDARD 105.

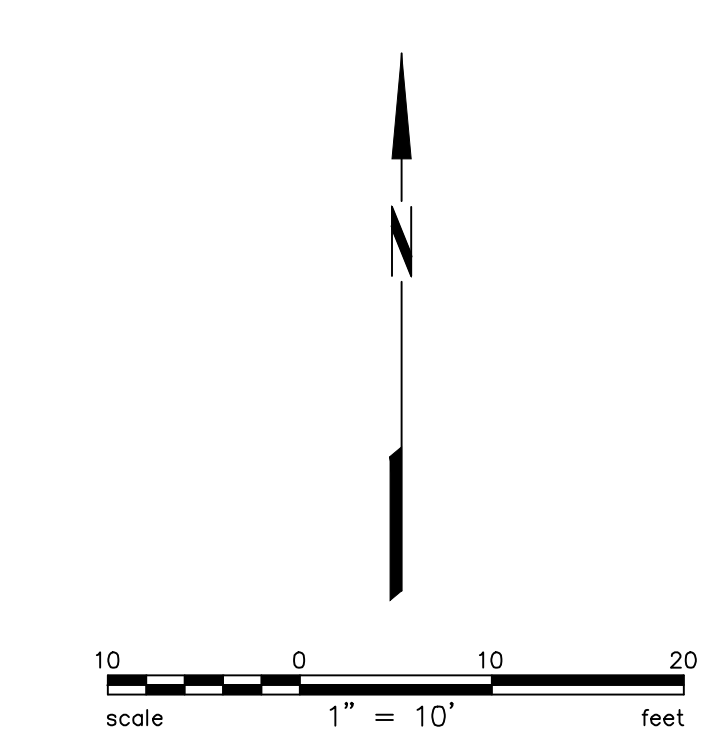

AD
Architecture.
Design.
Relationships.

Seal
REGISTERED PROFESSIONAL ARCHITECT
CALIFORNIA
No. C 80868

Consultant
BKF
200 4th STREET
SUITE 300
SANTA ROSA, CA 95401
(707) 583-8500
www.bkf.com

Client
THE PACIFIC COMPANIES
430 E. State Street, Suite 100
Eagle, ID 83616
(208) 908-4873

DRAKE MARIN CITY APTS
825 DRAKE AVENUE
COUNTY OF MARIN, CA 94065

GRADING PLAN

SUBMITTAL - 07/10/2024
Project Number: 2020-074
Plan Check Number: 2

ASI #01 05/28/2024
ASI #02 07/10/2024

SHEET
C3

