

EXHIBIT "A"

DESCRIPTION

All that certain real property in the County of Marin, State of California, described as follows:

An easement over a portion of Parcel One as described in that certain Grant Deed from Leonard D. Rosenman and Helen Rosenman to John E. Rosenman and Andrea M. Rosenman dated January 2, 1997, recorded as Document Number 1997-002584 in the office of the Marin County Recorder, and whose centerline is described as follows:

Beginning at a point along the northeasterly line of Parcel A as shown on that certain map entitled, "Parcel Map, Lands of Thomas Allen as described in Document No. 98-0067512", recorded in Book 1999 of Maps at Page 226, filed November 30, 1999 in the office of the Marin County Recorder, that bears North 53°04'00" West 71.83 feet from the easterly corner of said Parcel A monumented with a ½" rebar and cap L.S. 5379;

1. Thence leaving said northeasterly line, North 53°45'32" East 73.02 feet;
2. Thence North 15°54'34" East 52.00 feet to the Point of Termination.

The legal description herein is based upon a survey made by Lawrence P. Doyle Land Surveyor/Civil Engineer in September of 2011. The bearings contained herein are based upon the boundary lines of Parcels A and B as shown upon the map filed for record in Book 1999 of Maps at Page 226, Marin County Records.

This description was prepared by:

Lawrence P. Doyle

Lawrence P. Doyle
P.L.S. 4694
Exp. 9/30/13

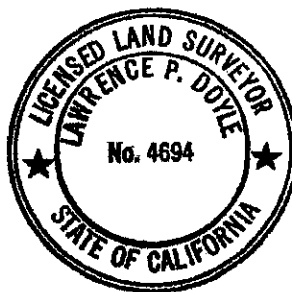

LANDS OF ROSENMAN
 PARCEL ONE
 D.N. 1997-002584
 A.P. 188-140-21

N11°11'00"E

N62°00'00"W
 148.92'

S79°22'00"W
 94.25'

S18°48'45"W
 54.20'

PORTION OF RANCHO LAS BAULINES
 TOWNSHIP 1N, RANGE 8W

N53°04'00"W

POINT OF TERMINATION

N15°54'34"E
 52.00'

N53°45'32"E
 73.02'

POINT OF BEGINNING

71.83'

FOUND REBAR/CAP
 L.S. 5379

A.P. 188-140-69
 PARCEL A
 1999 M 226

582.01'

BASIS OF BEARING
 N64°10'08"E
 S81°17'11"E
 A.P. 188-140-70
 PARCEL B
 1999 M 226

HORSESHOE HILL ROAD

FOUND REBAR/CAP
 L.S. 5379

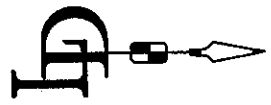

EXHIBIT 'B'	
PARCEL ONE PER D.N. 1997-002584	
BOLINAS MARIN COUNTY CALIFORNIA	
SCALE: 1" = 80'	DRAWN BY: SHEET 2 OF 2
DATE: 9/19/11	LAWRENCE P. DOYLE
LAND SURVEYOR/CIVIL ENGINEER	
100 HELENS LANE MILL VALLEY CA 94941 (415-388-9585)	
	DRAWING NO. 2072