

COUNTY OF MARIN, STATE OF CALIFORNIA

ONSITE WASTEWATER SYSTEM AND STORMWATER DRAINAGE SYSTEM

PRS CUI FAMILY SUBDIVISION

APN 119-050-04 & -05, 119-140-03 & -09



OWNER

CUI FAMILY TRUST
15906 VIA PATO
RANCHO SANTA FE, CA 92067

CONTACT: YAN CUI
EMAIL: YANCUIW@GMAIL.COM
TELEPHONE: (858) 245-0605

APPLICANT

STETSON ENGINEERS INC.

2171 E. FRANCISCO BLVD, SUITE K
SAN RAFAEL, CA 94901

CONTACT: XIAOQING ZENG, PHD, PE
EMAIL: XIAOQINGZ@STETSONENGINEERS.COM
TELEPHONE: (415) 457-0701

ENGINEER

NEXGEN ENGINEERING & CONSULTING LLC
1043 NICHOLS DRIVE, SUITE 200
ROCKLIN, CA 95765

CONTACT: IAN M. COLE, PE
EMAIL: IAN@NEXGENENG.COM
TELEPHONE: (866) 269-0999

ABBREVIATIONS

| | |
|--------|--|
| APN | ASSESSOR PARCEL NUMBER |
| ARP | AGRICULTURE RESIDENTIAL PLANNED |
| APZ | AGRICULTURAL PROTECTION ZONE |
| EXIST. | EXISTING |
| ESHA | ENVIRONMENTALLY SENSITIVE HABITAT AREA |
| FG | FINISH GRADE |
| FEMA | FEDERAL EMERGENCY MANAGEMENT AGENCY |
| HP | HIGH POINT |
| LP | LOW POINT |
| MALT | MARIN AGRICULTURAL LAND TRUST |
| P/L | PROPERTY LINE |
| PROP. | PROPOSED |
| RA | RESIDENTIAL AGRICULTURAL |
| RMP | RESIDENTIAL MULTIPLE PLANNED |

LEGEND

| | |
|---------|--------------------------------|
| (XX.XX) | EXISTING ELEVATION |
| --- | EXISTING PROPERTY LINE |
| --- | EXISTING RIGHT OF WAY |
| --- | EXISTING EASEMENT |
| --- | EXISTING FENCE |
| ○ | EXISTING TREE |
| ⊙ | EXISTING WELL |
| --- | EXISTING MAJOR CONTOUR |
| --- | EXISTING FLOW LINE |
| --- | EXISTING RIDGELINE |
| --- | PROJECT BOUNDARY |
| --- | PROPOSED LOT BOUNDARY |
| --- | PROPOSED EASEMENT |
| --- | PROPOSED MAJOR CONTOUR |
| --- | SLOPE INDICATOR |
| --- | SLOPE (IF > 4:1) |
| --- | PROPOSED DAYLIGHT LINE |
| --- | PROPOSED FLOW LINE |
| --- | PROPOSED RETAINING WALL |
| --- | PROPOSED STORM DRAIN |
| --- | PROPOSED BIORETENTION FACILITY |
| --- | PROPOSED AC ROADWAY |
| --- | FEMA FLOOD ZONE |
| --- | ESHA BUFFER |



VICINITY MAP
NOT TO SCALE

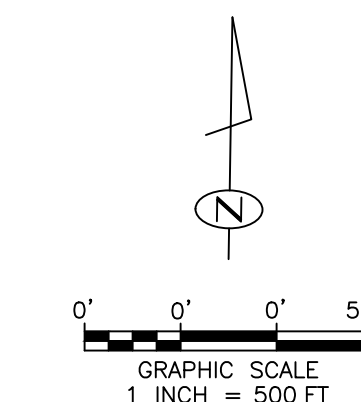
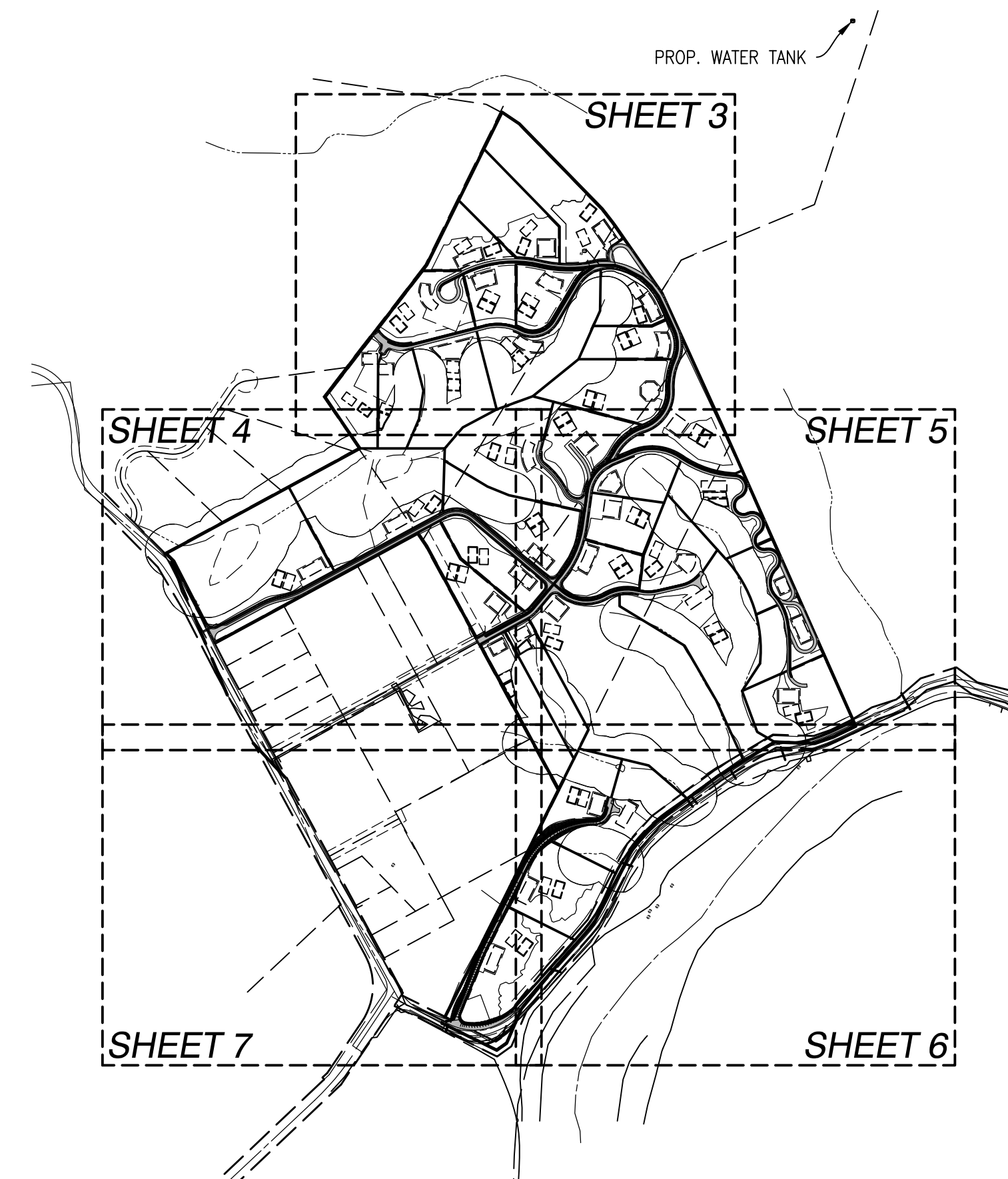

| INDEX OF SHEETS: | | |
|------------------|---------|-------------|
| SHEET NO. | DWG NO. | SHEET NAME |
| 1 | G1 | TITLE SHEET |
| 2 | G2 | NOTES |
| 3 | C1 | OWS PLAN 1 |
| 4 | C2 | OWS PLAN 2 |
| 5 | C3 | OWS PLAN 3 |
| 6 | C4 | OWS PLAN 4 |
| 7 | C5 | OWS PLAN 5 |

| REV. | DATE | DESCRIPTION |
|------|------|-------------|
| | | |
| | | |
| | | |

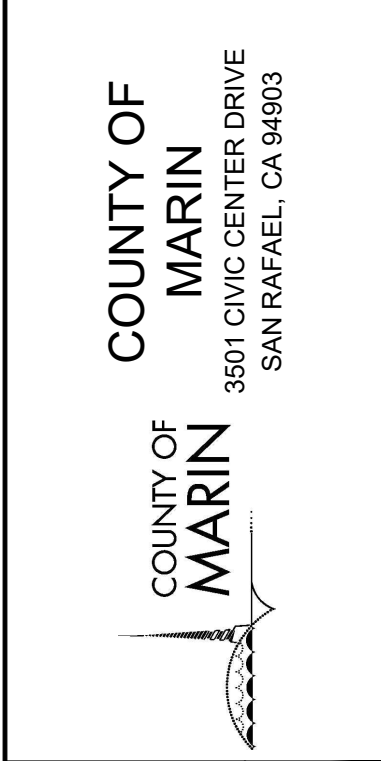

PRS CUI FAMILY SUBDIVISION
APN 119-050-04 & -05, 119-140-03 & -09
HIGHWAY 1, POINT REYES STATION, CA 94956
OWS PRIVATE IMPROVEMENT PLANS
TITLE SHEET

| | |
|--------------|----------|
| PROJECT NO: | 7731.04 |
| DATE: | 09-23-24 |
| DESIGNED BY: | IC/AK |
| DRAWN BY: | JS |
| CHECKED BY: | IC/LB |

We hereby expressly reserve the property rights to this drawing and it is not to be reproduced, copied in any format or manner whatsoever without first obtaining our express written permission and consent.

DRAWING:
G1
SHEET 1 OF 7

| PRELIMINARY DISPERSAL SYSTEM SIZING | | | | | |
|-------------------------------------|----------------------------|--|---------------------------|-------------------------------------|--|
| NUMBER OF BEDROOMS | WASTEWATER FLOW RATE (GPD) | WASTEWATER APPLICATION RATE (GPD/FT ²) | WASTEWATER FLOW REDUCTION | ADJUSTED WASTEWATER FLOW RATE (GPD) | MINIMUM ABSORPTION AREA (FT ²) |
| 3 | 450 | 0.2 | 30% | 315 | 1,575 |
| 4 | 600 | 0.2 | 30% | 420 | 1,680 |

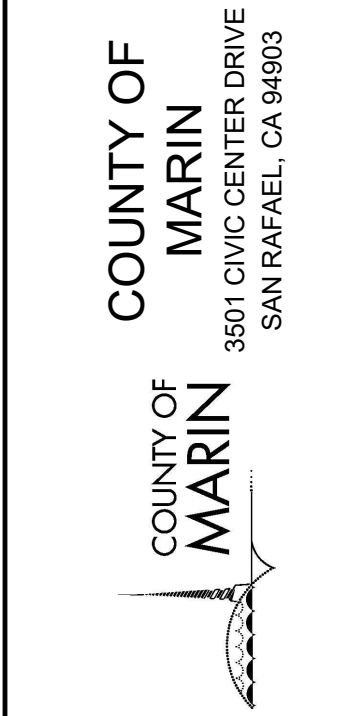

PRS CUI FAMILY SUBDIVISION
APN 19-050-04 & -05, 119-140-03 & -09
HIGHWAY 1, POINT REYES STATION, CA 94956
OWS PRIVATE IMPROVEMENT PLANS
NOTES

PROJECT NO: 7731.04
DATE: 09-23-24
DESIGNED BY: IC/AK
DRAWN BY: JS
CHECKED BY: IC/LB

We hereby expressly reserve the property rights to this drawing and it is not to be reproduced, copied in any format or manner whatsoever without first obtaining our express written permission and consent.

DRAWING:
G2
SHEET 2 OF 7

Drawing Name: Z:\NexGen E&C\Engineering\Projects\7731 Point Reyes Station CA\CAO\Sawer Plan\7731-SWR.dwg
 Last Opened: Jan 06, 2025 - 12:54pm by abhazeppul

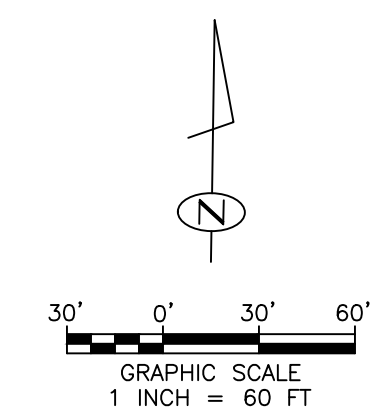

| REV. | DATE | DESCRIPTION |
|------|------|-------------|
| | | |
| | | |
| | | |

COUNTY OF MARIN
 3501 CIVIC CENTER DRIVE
 SAN RAFAEL, CA 94903

PRS CUI FAMILY SUBDIVISION
APN 119-050-04 & -05, 119-140-03 & -09
HIGHWAY 1, POINT REYES STATION, CA 94956
OWS PRIVATE IMPROVEMENT PLANS
OWS PLAN 1

PROJECT NO: 7731.04
 DATE: 09-23-24
 DESIGNED BY: IC/AK
 DRAWN BY: JS
 CHECKED BY: IC/LB

We hereby expressly reserve the property rights to this drawing and it is not to be reproduced, copied in any format or manner whatsoever without first obtaining our express written permission and consent.

Drawing Name: Z:\NexGen E&C\Engineering\Projects\7731 Point Reyes Station CA\CAO\Water Plan\7731-SWR.dwg
 Last Opened: Jan 06, 2025 - 12:55pm by ahzoeppol

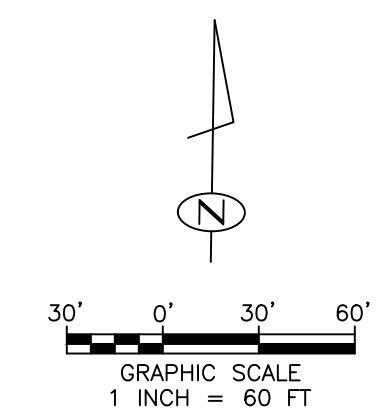
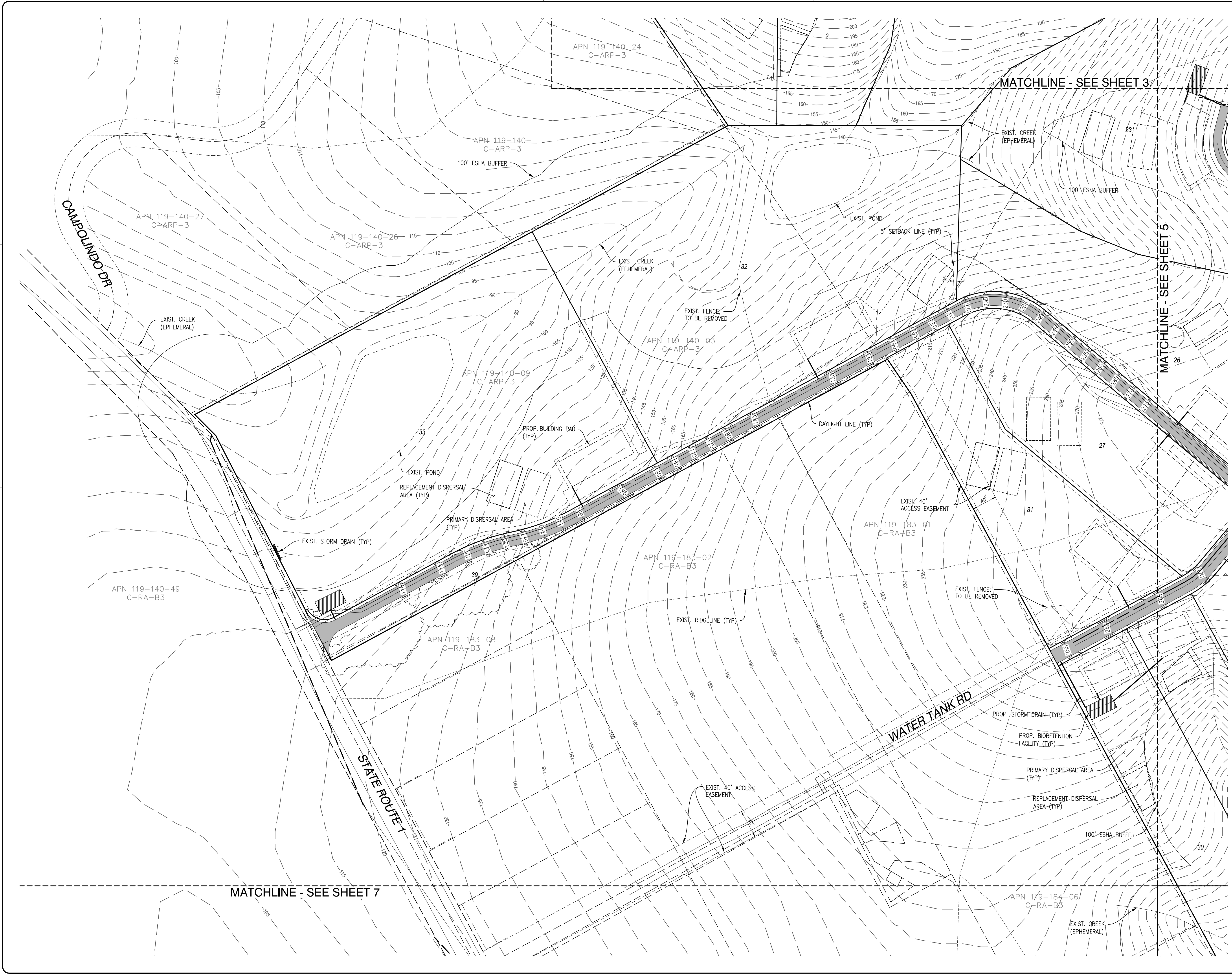

| REV. | DATE | DESCRIPTION |
|------|------|-------------|
| | | |
| | | |
| | | |

COUNTY OF MARIN
 3501 CIVIC CENTER DRIVE
 SAN RAFAEL, CA 94903

PRS CUI FAMILY SUBDIVISION
APN 119-050-04 & -05, 119-140-03 & -09
HIGHWAY 1, POINT REYES STATION, CA 94956
OWS PRIVATE IMPROVEMENT PLANS
OWS PLAN 2

PROJECT NO: 7731.04
 DATE: 09-23-24
 DESIGNED BY: IC/AK
 DRAWN BY: JS
 CHECKED BY: IC/LB

We hereby expressly reserve the property rights to this drawing and it is not to be reproduced, copied in any format or manner whatsoever without first obtaining our express written permission and consent.

DRAWING:
C2
 SHEET 4 OF 7

Drawing Name: Z:\NexGen_E&C\Engineering\Projects\7731 Point Reyes Station CA\CAO\Water Plan\7731-SWR.dwg
 Last Opened: Jan 06, 2025 - 12:55pm by ahzoeipool

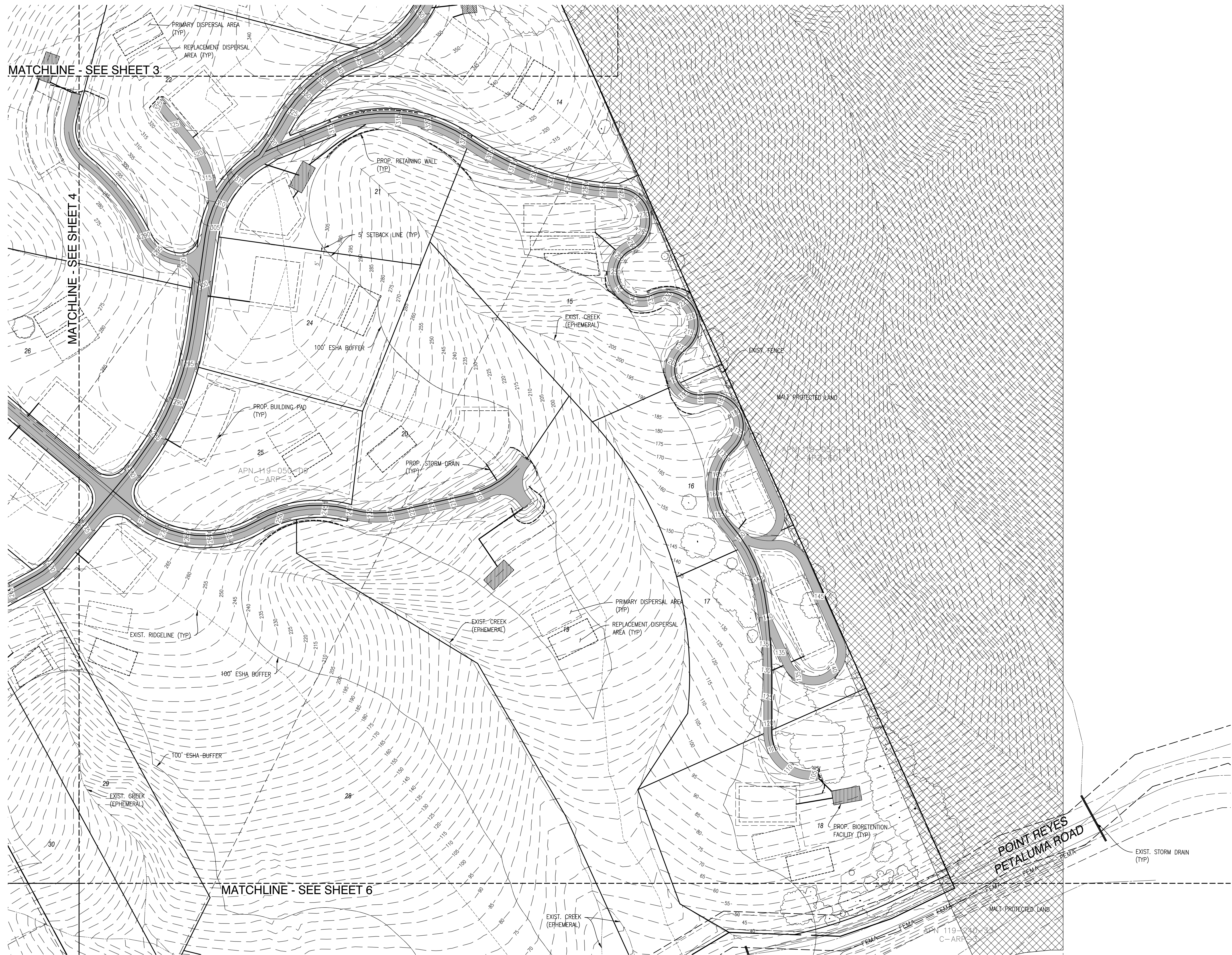

| REV. | DATE | DESCRIPTION |
|------|------|-------------|
| | | |
| | | |
| | | |
| | | |

COUNTY OF MARIN
 3501 CIVIC CENTER DRIVE
 SAN RAFAEL, CA 94903

PRS CUI FAMILY SUBDIVISION
APN 19-050-04 & -05, 119-140-03 & -09
HIGHWAY 1, POINT REYES STATION, CA 94956
OWS PRIVATE IMPROVEMENT PLANS
OWS PLAN 3

PROJECT NO: 7731.04
 DATE: 09-23-24
 DESIGNED BY: IC/AK
 DRAWN BY: JS
 CHECKED BY: IC/LB

We hereby expressly reserve the property rights to this drawing and it is not to be reproduced, copied in any format or manner whatsoever without first obtaining our express written permission and consent.

DRAWING:
C3
 SHEET 5 OF 7

Drawing Name: Z:\NexGen_E&C\Engineering\Projects\7731 Point Reyes Station CA\CAO\Sewer Plan\7731-SWR.dwg
 Last Opened: Jan 06, 2025 - 12:55pm by akhazepoul

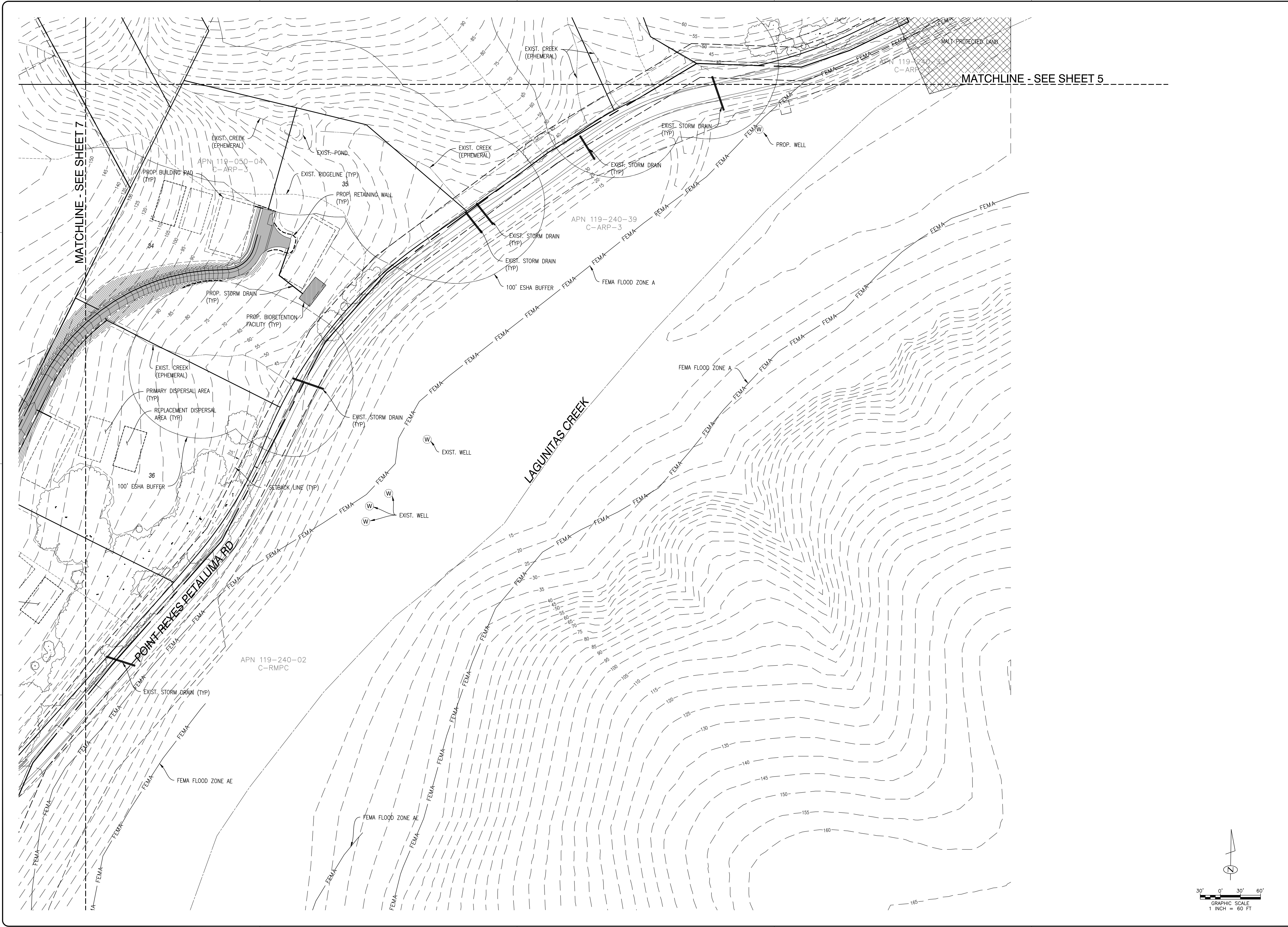

| REV. | DATE | DESCRIPTION |
|------|------|-------------|
| | | |
| | | |
| | | |

COUNTY OF MARIN
 3501 CIVIC CENTER DRIVE
 SAN RAFAEL, CA 94903

PRS CUI FAMILY SUBDIVISION
APN 119-050-04 & -05, 119-140-03 & -09
HIGHWAY 1, POINT REYES STATION, CA 94956
OWS PRIVATE IMPROVEMENT PLANS
OWS PLAN 4

PROJECT NO: 7731.04
 DATE: 09-23-24
 DESIGNED BY: IC/AK
 DRAWN BY: JS
 CHECKED BY: IC/LB

We hereby expressly reserve the property rights to this drawing and it is not to be reproduced, copied in any format or manner whatsoever without first obtaining our express written permission and consent.

DRAWING: **C4**
 SHEET 6 OF 7

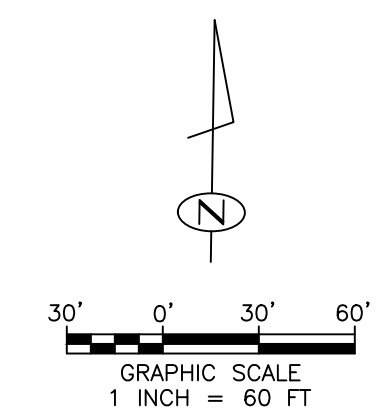

Drawing Name: Z:\NexGen_E&C\Engineering\Projects\7731 Point Reyes Station CA\CAO\Water Plan\7731-SWR.dwg
 Last Opened: Jan 06, 2025 - 12:55pm by ahzoeipool

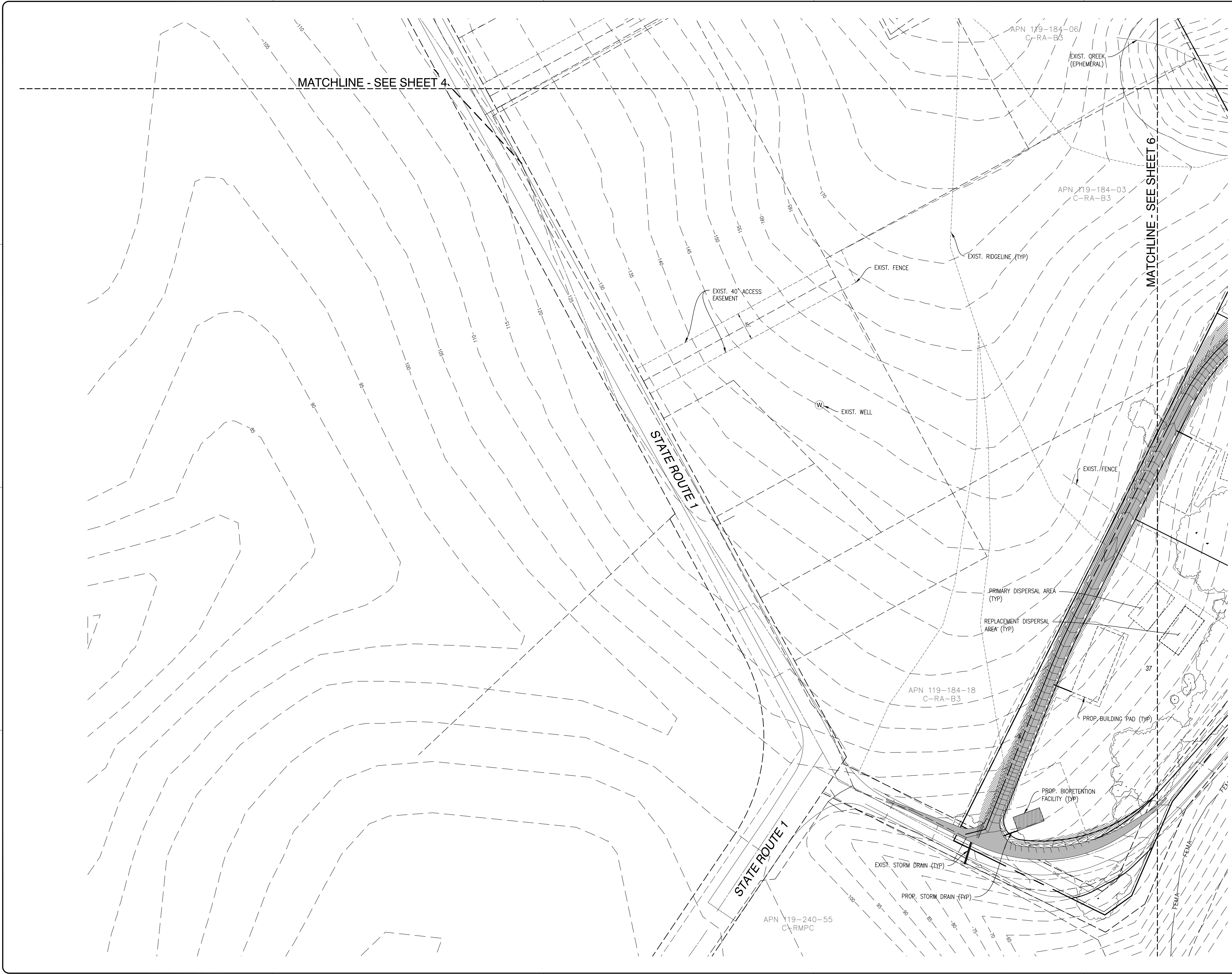

| REV. | DATE | DESCRIPTION |
|------|------|-------------|
| | | |
| | | |
| | | |

COUNTY OF MARIN
 3501 CIVIC CENTER DRIVE
 SAN RAFAEL, CA 94903

PRS CUI FAMILY SUBDIVISION
APN 119-050-04 & -05, 119-140-03 & -09
HIGHWAY 1, POINT REYES STATION, CA 94956
OWS PRIVATE IMPROVEMENT PLANS
OWS PLAN 5

PROJECT NO: 7731.04
 DATE: 09-23-24
 DESIGNED BY: IC/AK
 DRAWN BY: JS
 CHECKED BY: IC/LB

We hereby expressly reserve the property rights to this drawing and it is not to be reproduced, copied in any format or manner whatsoever without first obtaining our express written permission and consent.

DRAWING:
C5
 SHEET 7 OF 7