

CONSTRUCTION GENERAL NOTES

1. ALL WORK SHALL BE COMPLETED IN COMPLIANCE WITH BAY AREA AIR QUALITY MANAGEMENT DISTRICT (BAAQMD) RULES FOR FUGITIVE DUST GENERATION AND TRACKOUT. THE WORK SHALL, AT MINIMUM, IMPLEMENT BAAQMD'S BASIC CONTROL MEASURES, INCLUDING CONTROLLING FUGITIVE DUST BY SPRAYING ACTIVE WORK AREAS WITH WATER AND COVERING INACTIVE STOCKPILES.
2. BEST MANAGEMENT PRACTICES (BMPs) SHALL BE IMPLEMENTED AND MAINTAINED IN ACCORDANCE WITH THE STORM WATER POLLUTION PREVENTION PLAN PREPARED BY THE PROJECT CIVIL ENGINEER.
3. TREE PROTECTION MEASURES AND ENVIRONMENTAL SAFEGUARDS SHALL BE INSTALLED AND MAINTAINED DURING CONSTRUCTION IN ACCORDANCE WITH THE TREE PROTECTION PLAN PREPARED BY THE PROJECT ARBORIST.

Construction Program Requirements

A construction program shall contain a number of components related to development activities, including the following:

- A. A site plan showing areas where grading and construction will take place, soils will be stockpiled, laydown areas for building materials, parking for construction workers, and temporary facilities such as portable toilets, construction signs, temporary areas for secure storage and construction trailers will be located. The location of power generators or temporary power poles shall also be shown.
- B. Dust reduction consistent with the Bay Air Quality Management District's basic control measures.
- C. An erosion control and/or storm water pollution prevention plan, as required by the Department of Public Works.
- D. A traffic control plan, as required by the Department of Public Works.
- E. The location and design of tree protection fencing and any other fencing necessary to provide environmental safeguards during construction.
- F. Construction phasing and the timing during any given year when the various components of construction will occur, such as grading, tree and

LIMITS OF
GRADING &
CONSTRUCTION
WORK

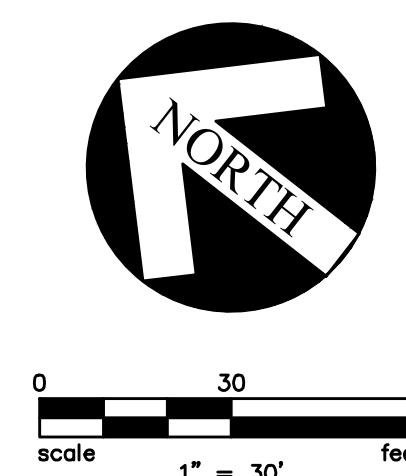

CONSTRUCTION POINTS OF CONTACT:

Kerry Eldredge
Field Superintendent
(916) 202-1381
Keldredge@milestoneconstructiongrp.com

Sriram Kora
Project Manager
(408) 677-6654
Sriram@milestoneconstructiongrp.com





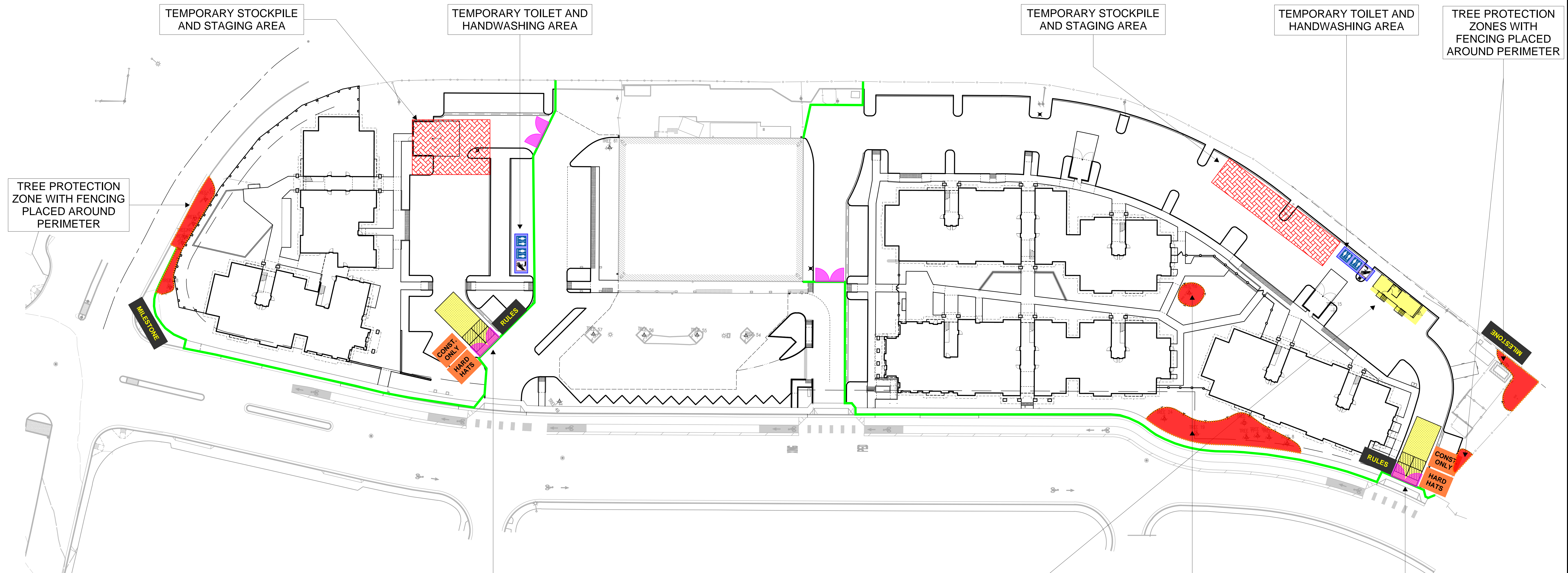

CONSTRUCTION STAGING AND PHASING SHEET INDEX

CONST - 0.0	TITLE SHEET & LIMITS OF WORK
CONST - 1.0	CONSTRUCTION STAGING
CONST - 1.1	PEDESTRIAN TRAFFIC CONTROL PLAN
CONST - 2.0	CONSTRUCTION TEMPORARY POWER PLAN
PHASE - 1.0	MOBILIZATION & DEMOLITION
PHASE - 2.0	GRADING & GROUND IMPROVEMENTS
PHASE - 3.0	UTILITIES & FOUNDATIONS
PHASE - 4.0	FRAMING & A/C PAVING
PHASE - 5.0	EXTERIOR / INTERIOR FINISHES
PHASE - 6.0	FINISH SITE WORK & FINAL INSPECTIONS

DATE 12-08-2025

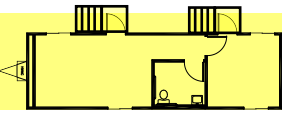

LEGEND

- TEMPORARY FENCE W/ SCREEN —
- DOUBLE SWING GATE 
- TEMPORARY RESTROOM AND HANDWASHING AREA 
- STABILIZED CONSTRUCTION ENTRANCE 
- CONSTRUCTION TRAILER (40x12) W/ HOLDING TANK 
- MILESTONE CONSTRUCTION SIGN / BANNER 
- JOBSITE RULES SIGN 
- HARD HATS REQUIRED SIGN 
- CONSTRUCTION ENTRY ONLY SIGN 

PRIMARY CONSTRUCTION ENTRANCE & EXIT W/ STABILIZED ENTRY

TEMPORARY CONSTRUCTION TRAILER

TREE PROTECTION ZONES WITH FENCING PLACED AROUND PERIMETER

PRIMARY CONSTRUCTION ENTRANCE & EXIT W/ STABILIZED ENTRY

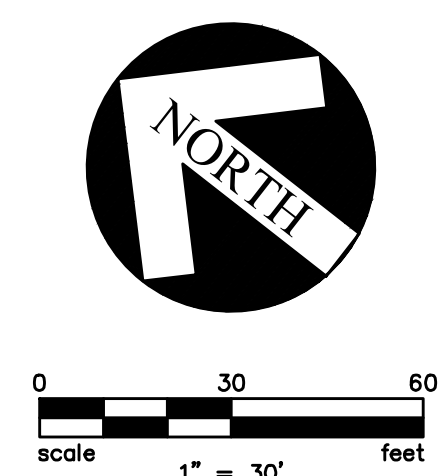

CONSTRUCTION POINTS OF CONTACT:

Kerry Eldredge
Field Superintendent
(916) 202-1381
Keldredge@milestoneconstructiongrp.com

Sriram Kora
Project Manager
(408) 677-6654
Sriram@milestoneconstructiongrp.com

DETAIL 1

**SIDEWALK
CLOSED**

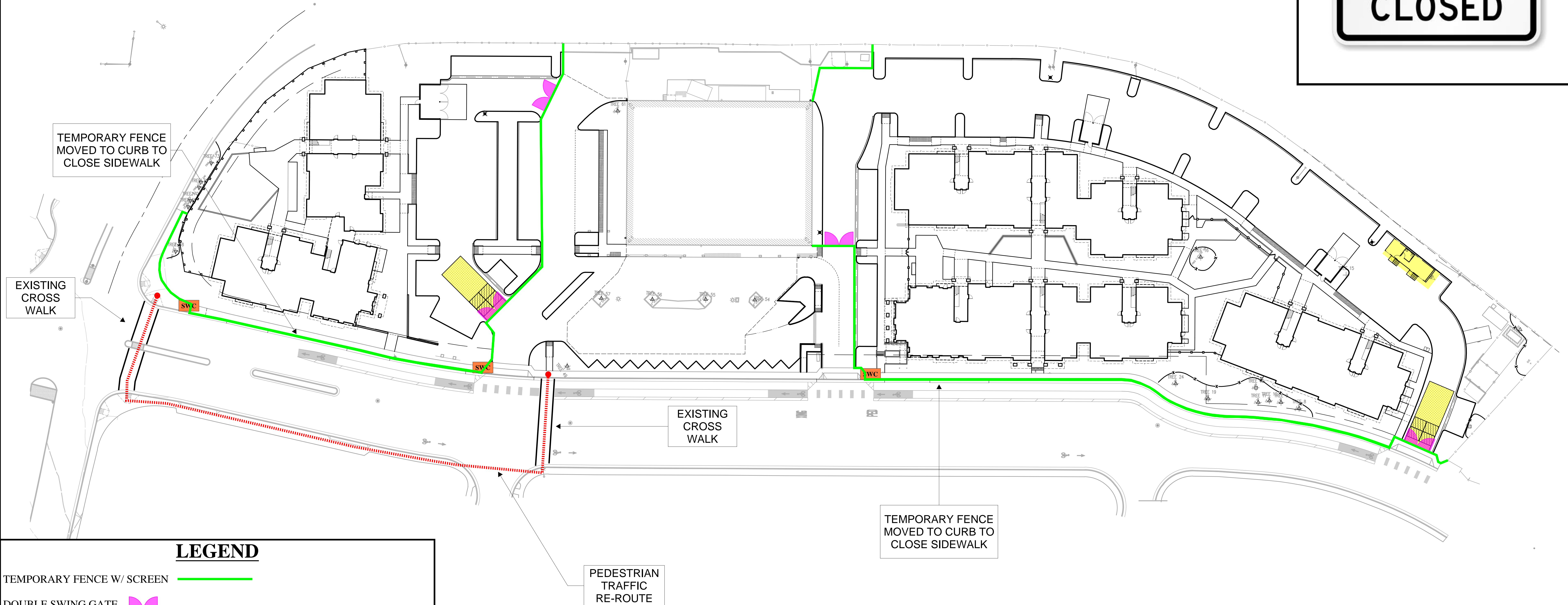

LEGEND

- TEMPORARY FENCE W/ SCREEN ———
- DOUBLE SWING GATE ⌞
- STABILIZED CONSTRUCTION ENTRANCE
- CONSTRUCTION TRAILER (40x12) W/ HOLDING TANK
- PEDESTRIAN TRAFFIC ROUTE ⋯⋯⋯
- SIDEWALK CLOSED SIGN MOUNTED TO FENCE (DETAIL 1) SWC

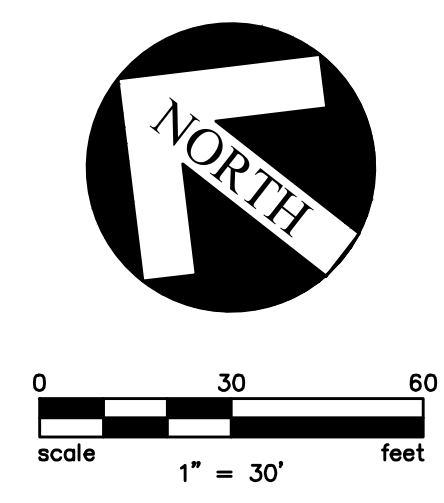

CONSTRUCTION POINTS OF CONTACT:

Kerry Eldredge
Field Superintendent
(916) 202-1381
Keldredge@milestoneconstructiongrp.com

Sriram Kora
Project Manager
(408) 677-6654
Sriram@milestoneconstructiongrp.com

DATE 12-08-2025

CONSTRUCTION TEMPORARY POWER PLAN

SHEET CONST - 2.0

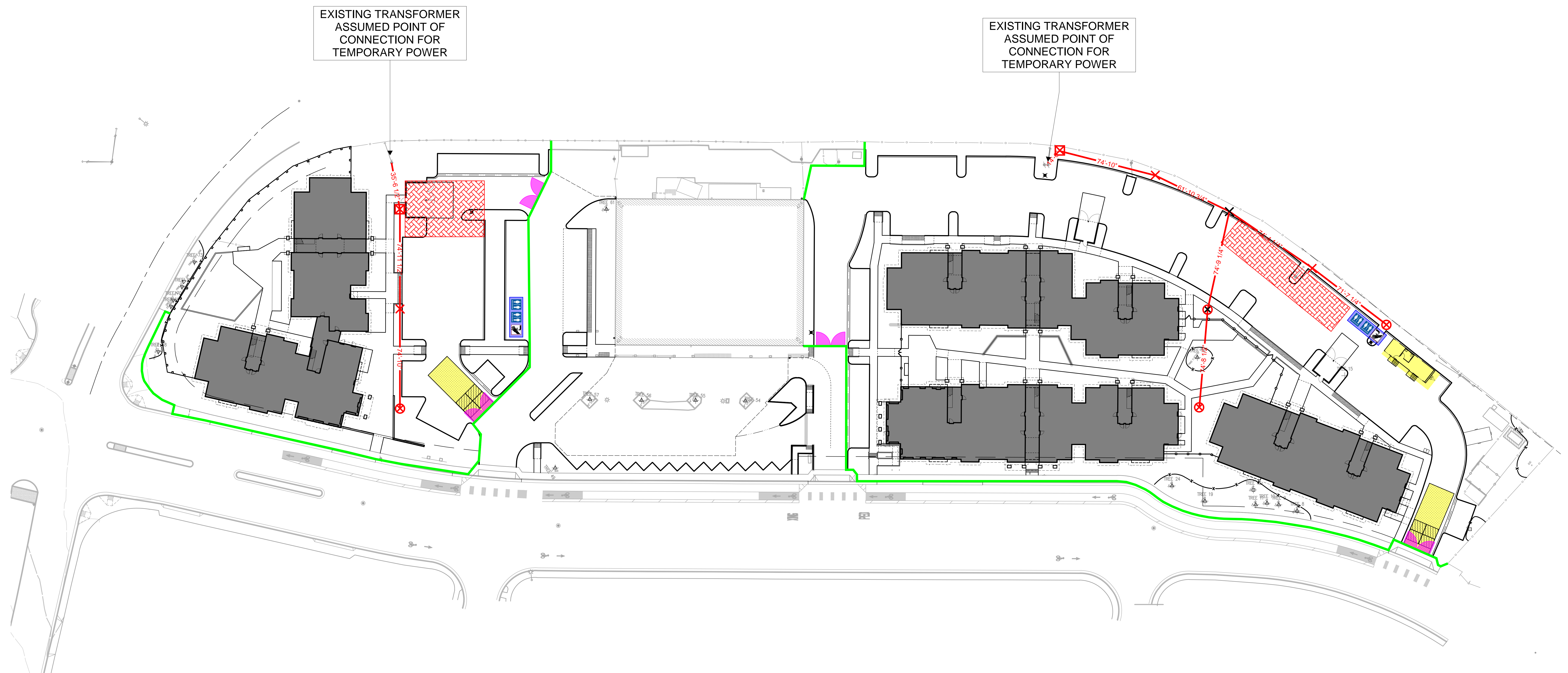

LEGEND

- TEMPORARY METER POLE ⊠
- TEMPORARY POLE/STUB W/ OUTLET(S) ⊗
- TEMPORARY POWER POLE ×
- TEMPORARY OVERHEAD POWER LINE —
- TEMPORARY POWER POLE (BLACK DIAMOND) ⊗

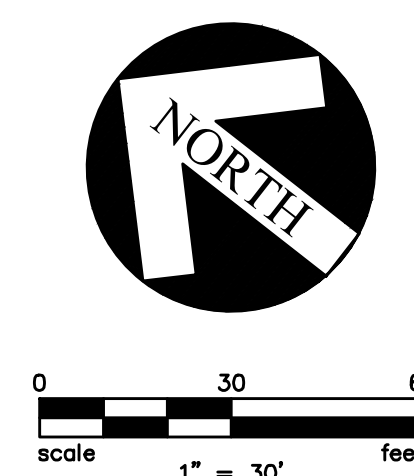

CONSTRUCTION POINTS OF CONTACT:

Kerry Eldredge
Field Superintendent
(916) 202-1381
Keldredge@milestoneconstructiongrp.com

Sriram Kora
Project Manager
(408) 677-6654
Sriram@milestoneconstructiongrp.com

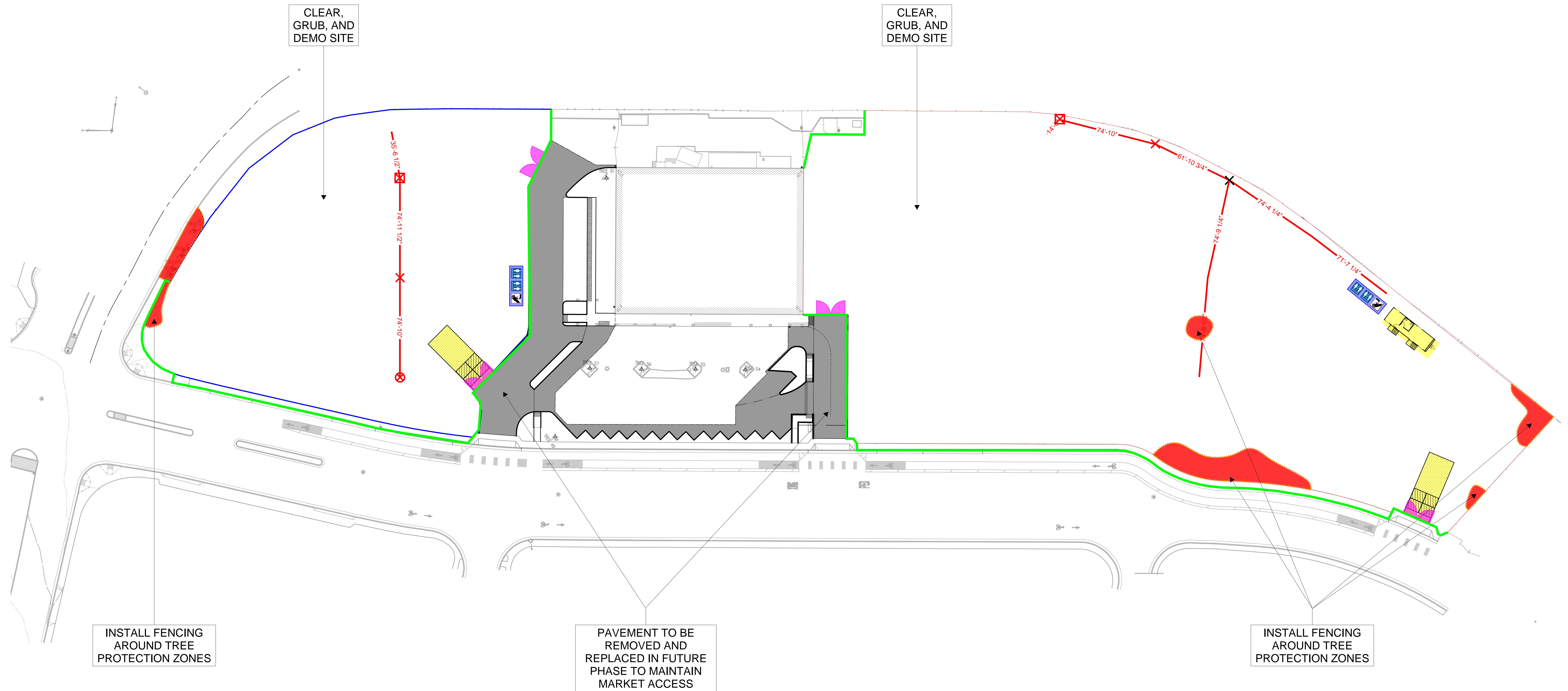

PHASE 1 - MOBILIZE & DEMO

APPROXIMATELY 1 MONTH (DECEMBER 2025 - JANUARY 2026)

MOBILIZE TEMPORARY FACILITIES, INCLUDING SET UP TEMPORARY FENCING, TEMPORARY TREE PROTECTION, SWPPP MEASURES / BMPS, TEMPORARY TRAILER, AND TEMPORARY POWER

DEMOLITION EXISTING ONSITE PAVEMENT AND CLEAR AND GRUB INVOLVING USE OF EXCAVATOR, POWER SAWS, AND DUMP TRUCKS HAULING DEMOLITION MATERIALS FROM THE SITE

CONSTRUCTION POINTS OF CONTACT:

Kerry Eldredge
Field Superintendent
(916) 202-1381
Keldredge@milestoneconstructiongrp.com

Sriram Kora
Project Manager
(408) 677-6654
Sriram@milestoneconstructiongrp.com

DATE 12-08-2025

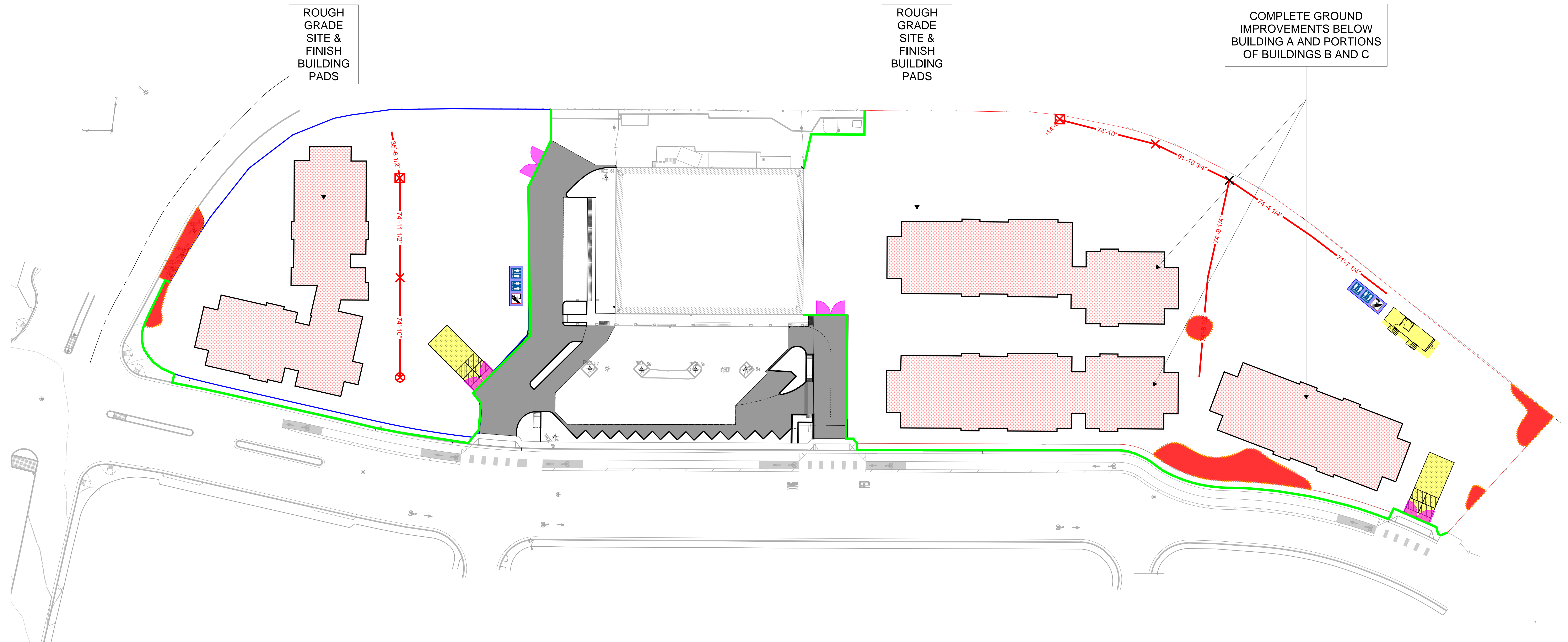

PHASE 2 - GRADING & GROUND IMPROVEMENTS

APPROXIMATELY 2 MONTHS (JANUARY 2026 - MARCH 2026)

ROUGH GRADE JOBSITE INVOLVING THE USE OF EXCAVATORS, GRADERS, BOBCATS, ROLLERS, COMPACTORS, AND POTENTIALLY DUMP TRUCKS TO IMPORT / EXPORT TO PRELIMINARILY BALANCE SITE

FINISH BUILDING PADS USING GRADER AND ROLLER

COMPLETE THE GROUND IMPROVEMENTS BELOW BUILDING 'A' AND PORTIONS OF BUILDINGS 'B' AND 'C' INVOLVES THE USE OF DRILL RIG, EXCAVATOR, AND BOBCAT

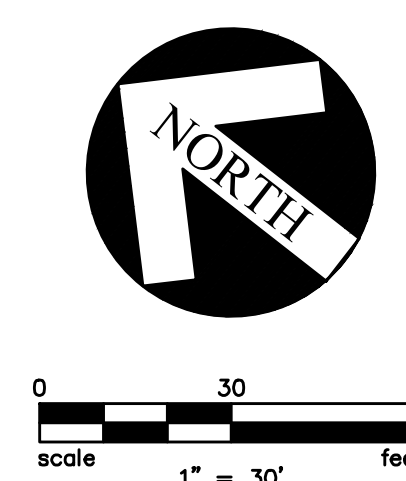

CONSTRUCTION POINTS OF CONTACT:

Kerry Eldredge
Field Superintendent
(916) 202-1381
Keldredge@milestoneconstructiongrp.com

Sriram Kora
Project Manager
(408) 677-6654
Sriram@milestoneconstructiongrp.com

DATE 12-08-2025

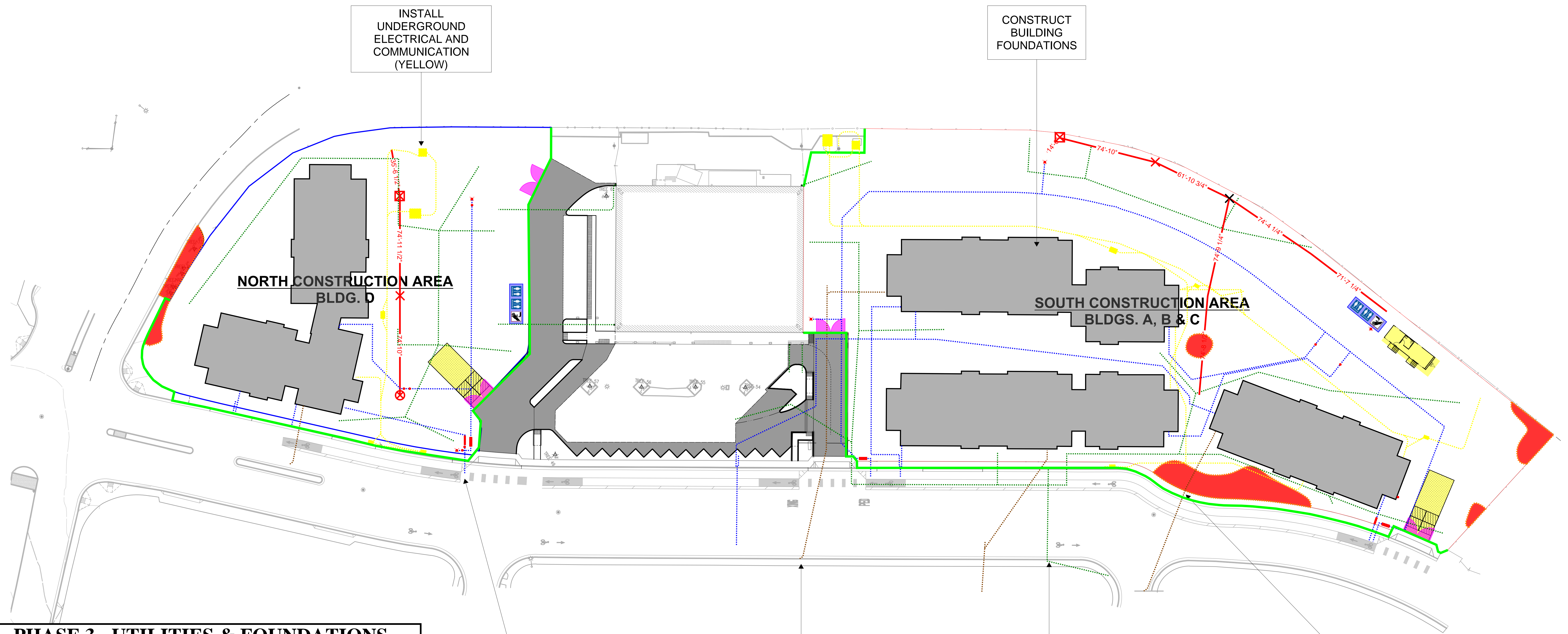

PHASE 3 - UTILITIES & FOUNDATIONS

APPROXIMATELY 4 MONTHS (FEBRUARY 2026 - JUNE 2026)

INSTALL UNDERGROUND UTILITIES INVOLVING USE OF EXCAVATOR, FLATBED TRUCKS FOR MATERIAL DELIVERIES, AND POTENTIALLY DUMP TRUCKS TO EXPORT EXCESS DIRT GENERATED

COORDINATE UTILITY INSTALLATION IN MARKET AREA / COMMON DRIVEWAY TO MAINTAIN PARTIAL ACCESS FOR MARKET AND TEMPORARY PATCH UTILITY TRENCHES

CONSTRUCT FOUNDATIONS INVOLVING USE OF EXCAVATOR, TELEHANDLER, CONCRETE BOOM TRUCK, CEMENT MIXER TRUCKS, FLATBED TRUCKS FOR DELIVERIES OF REINFORCING, AND POTENTIALLY DUMP TRUCKS FOR EXPORTING EXCESS DIRT GENERATED

PRIOR TO ALL OFFSITE UTILITY CONNECTIONS AND/OR OTHER OFFSITE IMPROVEMENT WORK, SUBMIT A TRAFFIC CONTROL PLAN TO PUBLIC WORKS FOR APPROVAL. PLEASE NOTIFY ALL NEIGHBORING PROPERTIES BY DISTRIBUTING A NOTICE OUTLINING THE UPCOMING CONSTRUCTION ON MARINWOOD AVENUE (ONLY FOR OFFSITE TIE INS AND OTHER IMPROVEMENTS), INCLUDING THE SPECIFIC DATES AND TIMES.

INSTALL UNDERGROUND WATER (BLUE)

INSTALL UNDERGROUND SEWER (BROWN)

INSTALL UNDERGROUND STORM (GREEN)

COORDINATE WITH PROJECT ARBORIST FOR UTILITY TRENCHES THROUGH TREE PROTECTION ZONE

CONSTRUCTION POINTS OF CONTACT:

Kerry Eldredge
Field Superintendent
(916) 202-1381
Keldredge@milestoneconstructiongrp.com

Sriram Kora
Project Manager
(408) 677-6654
Sriram@milestoneconstructiongrp.com

DATE 12-08-2025

PHASE 4 - FRAMING & A/C PAVING

SHEET PHASE - 4.0

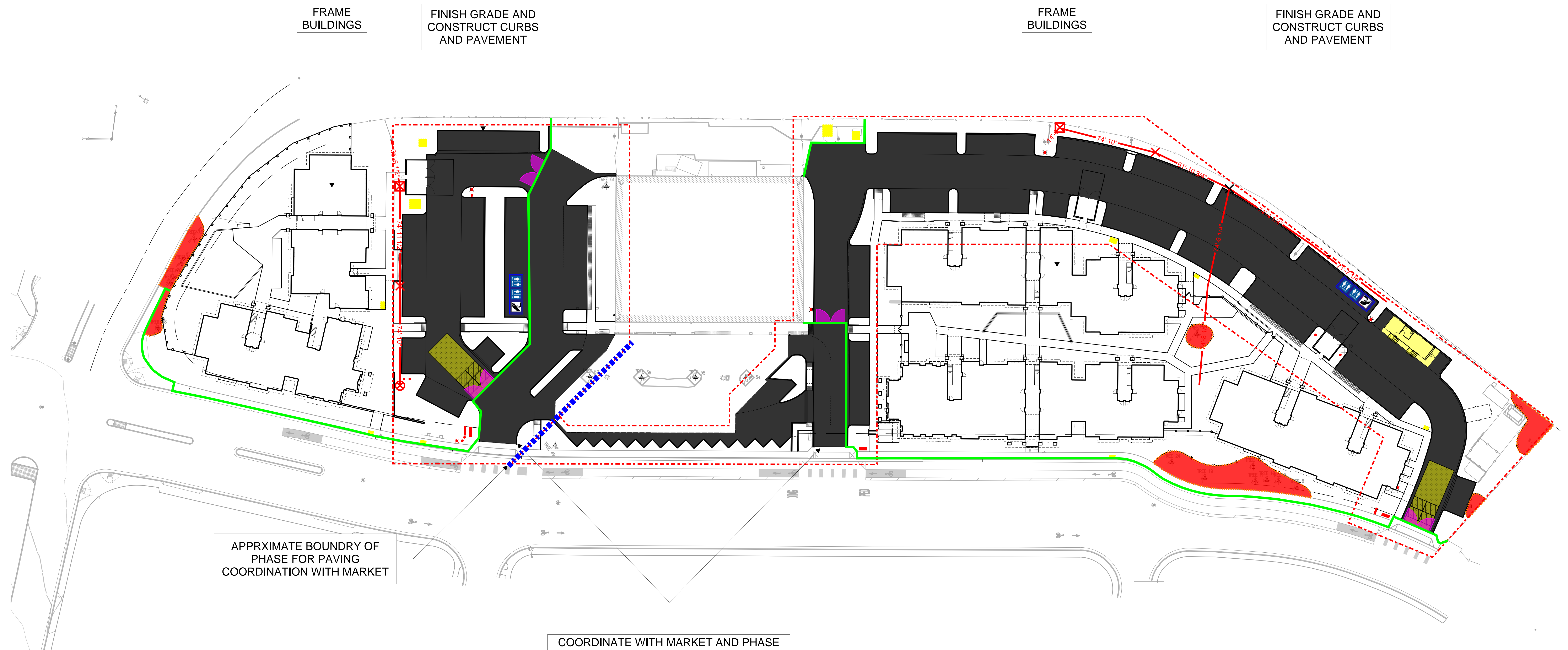

PHASE 4 - FRAMING & A/C PAVING

APPROXIMATELY 4 MONTHS (APRIL 2026 - AUGUST 2026)

FRAME BUILDINGS USING FLATBED TRUCKS FOR MATERIAL DELIVERIES, TELEHANDLER, COMPRESSORS AND POWER HAND TOOLS, AND MOBILE CRANE FOR SETTING OF TRUSSES

COORDINATE DEMOLITION OF MARKET DRIVE AREA IN PHASES TO MAINTAIN PARTIAL ACCESS DURING FINISHING OF MARKET CURBS & PAVEMENTS

FINISH GRADE AND COMPACT PAVEMENT BASE USING DUMP TRUCKS FOR DELIVERIES OF BASE MATERIAL, GRADER AND ROLLER.

CONSTRUCT CURBS, GUTTERS AND VEHICULAR CONCRETE USING SMALL HAND TOOLS AND CEMENT MIXER TRUCKS

PAVE ASPHALT PAVEMENT AREAS WITH PAVING MACHINE, DUMP TRUCKS FOR DELIVERIES OF ASPHALT, AND ROLLERS TO FINISH AND COMPACT ASPHALT

COORDINATE WITH MARKET AND PHASE DEMOLITION AND CONSTRUCTION OF MARKET DRIVE AND PARKING AREAS TO MAINTAIN LIMITED ACCESS DURING COMPLETION OF IMPROVEMENTS

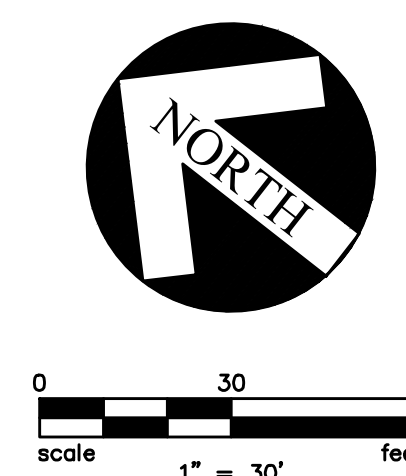

CONSTRUCTION POINTS OF CONTACT:

Kerry Eldredge
Field Superintendent
(916) 202-1381
Keldredge@milestoneconstructiongrp.com

Sriram Kora
Project Manager
(408) 677-6654
Sriram@milestoneconstructiongrp.com

DATE 12-08-2025

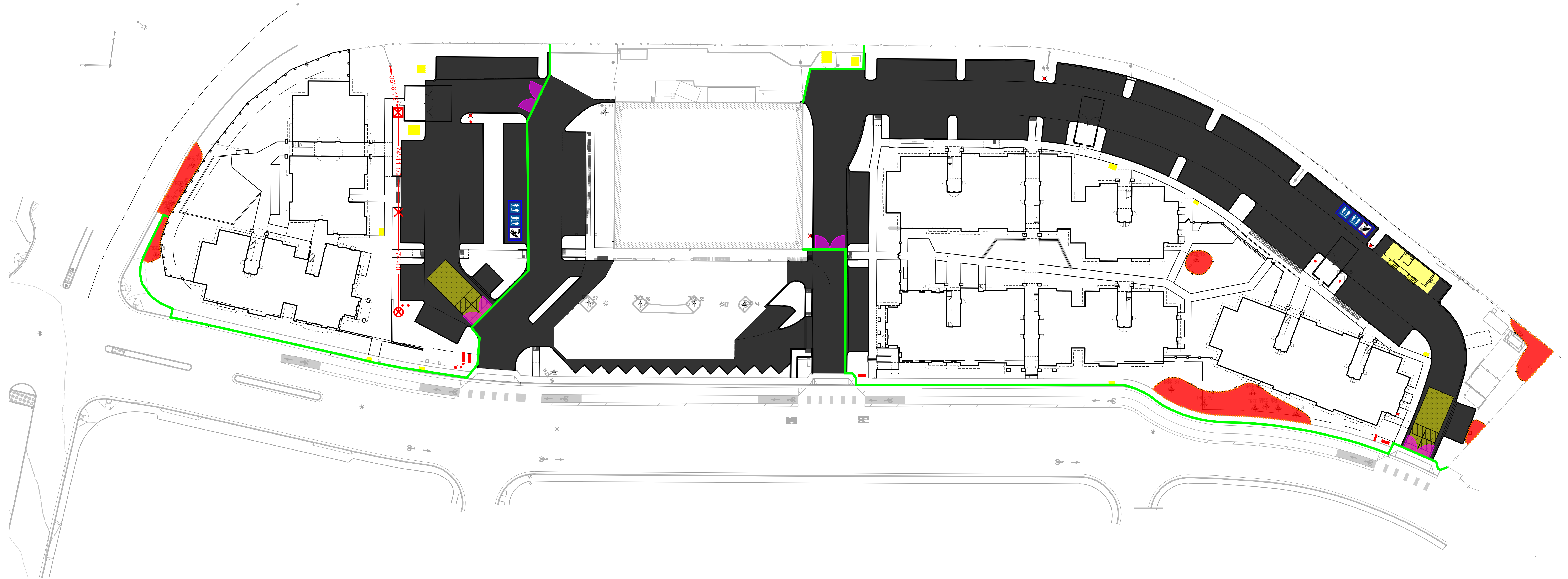

PHASE 5 - EXTERIOR / INTERIOR FINISHES

APPROXIMATELY 9 MONTHS (MAY 2026 - FEBRUARY 2027)

LOAD DRYWALL AND OTHER FINISHES INTO BUILDINGS USING TELEHANDLERS AND FLATBED DELIVERY TRUCKS

ERECT SCAFFOLDING AROUND BUILDINGS, INSTALL EXTERIOR DOORS AND WINDOWS, AND FINISH EXTERIORS / INTERIORS USING SMALL HANDTOOLS, POWER SAWS, COMPRESSORS, NAIL GUNS AND SPRAYERS

CONNECT PERMANENT POWER AND ENERGIZE BUILDINGS

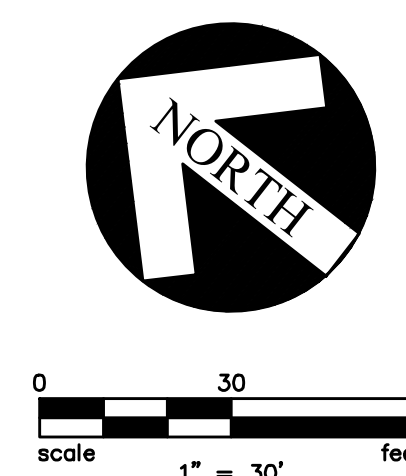

CONSTRUCTION POINTS OF CONTACT:

Kerry Eldredge
Field Superintendent
(916) 202-1381
Keldredge@milestoneconstructiongrp.com

Sriram Kora
Project Manager
(408) 677-6654
Sriram@milestoneconstructiongrp.com

DATE 12-08-2025

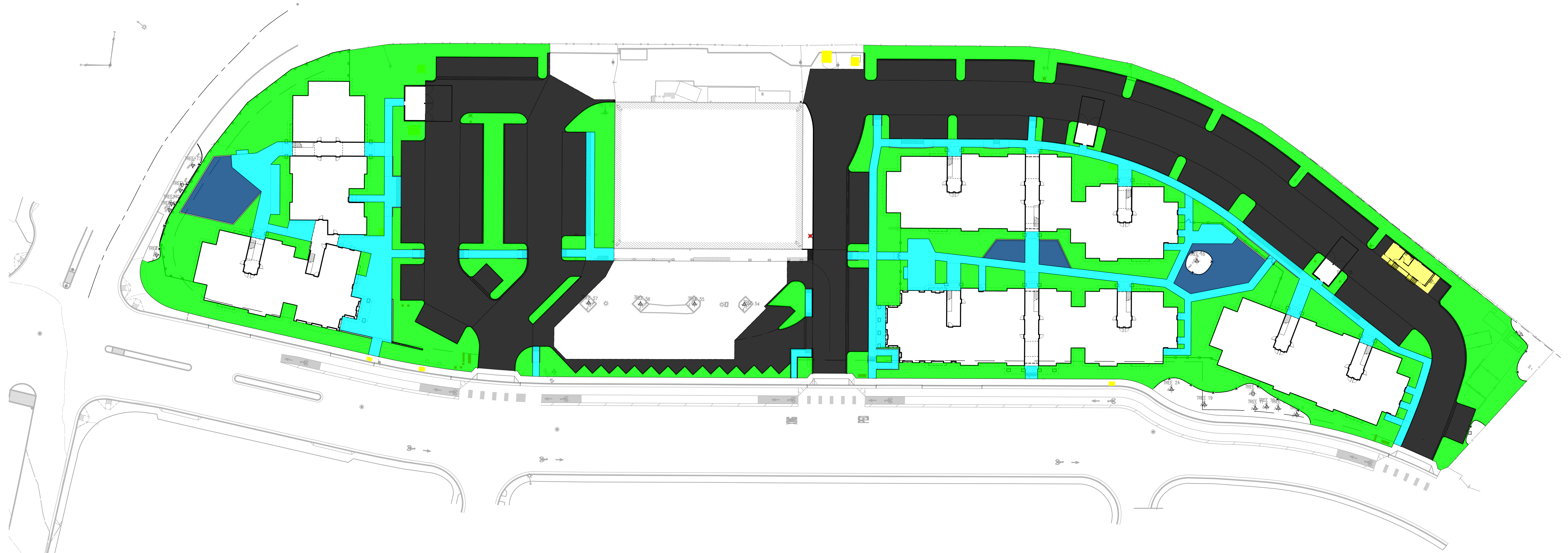

PHASE 6 - FINISH SITE WORK & FINAL INSPECTIONS

APPROXIMATELY 7 MONTHS (DECEMBER 2026 - JULY 2027)

REMOVE SCAFFOLDING AND TEMPORARY FACILITIES

FINISH GRADE AND COMPACT BASE AT PEDESTRIAN CONCRETE AND PLAYGROUND AREAS USING BOBCATS, DUMP TRUCKS, AND HAND COMPACTORS (JUMPING JACKS)

FORM AND POUR CURBS AND PEDESTRIAN PAVING USING SMALL HAND TOOLS AND CEMENT MIXER TRUCKS

FINISH GRADE LANDSCAPE AREAS, INSTALL IRRIGATION, AND PLANT USING SMALL HANDTOOLS

BEFORE FINAL INSPECTION, THE DESIGN PROFESSIONAL SHALL CERTIFY TO THE COUNTY THAT ALL ACCESSIBLE IMPROVEMENTS HAVE BEEN BUILT PER APPROVED PLAN AND COMPLY WITH ALL STATE AND FEDERAL ACCESSIBILITY REQUIREMENTS

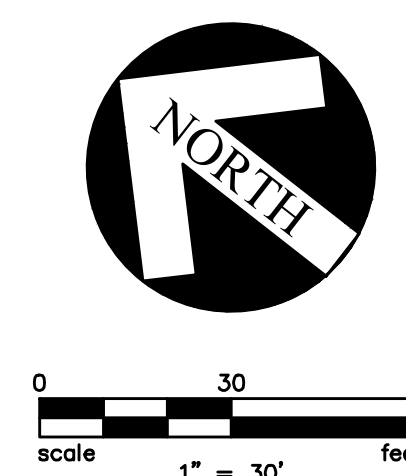

CONSTRUCTION POINTS OF CONTACT:

Kerry Eldredge
Field Superintendent
(916) 202-1381
Keldredge@milestoneconstructiongrp.com

Sriram Kora
Project Manager
(408) 677-6654
Sriram@milestoneconstructiongrp.com

DATE 06-09-2025

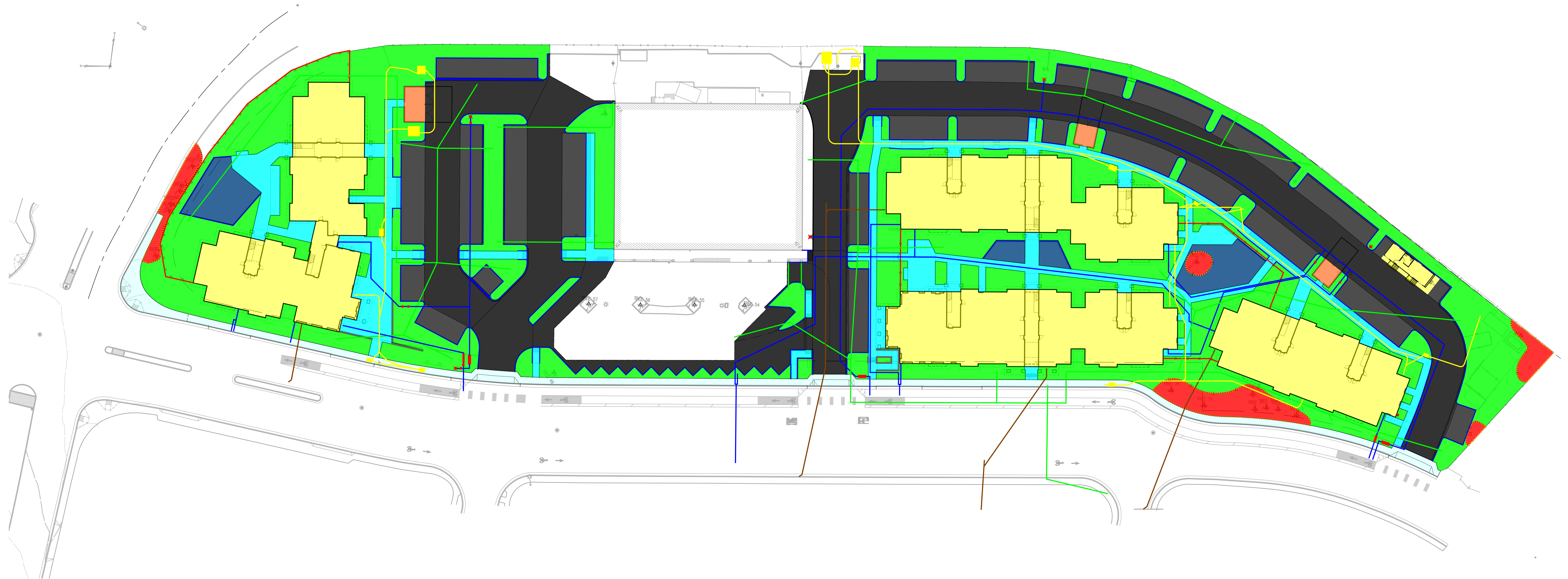

PHASE 1 - MOBILIZE & DEMO

APPROXIMATELY 1 MONTH (DECEMBER 2025 - JANUARY 2026)

SET UP SITE FENCING, TEMPORARY TREE PROTECTION, SWPPP MEASURES / BMPS, TEMPORARY TRAILER, AND TEMPORARY POWER

DEMOLITION EXISTING ONSITE PAVEMENT AND CLEAR AND GRUB INVOLVING USE OF EXCAVATOR, POWER SAWS, AND TRUCKS REMOVING DEMOLITION MATERIALS FROM THE SITE

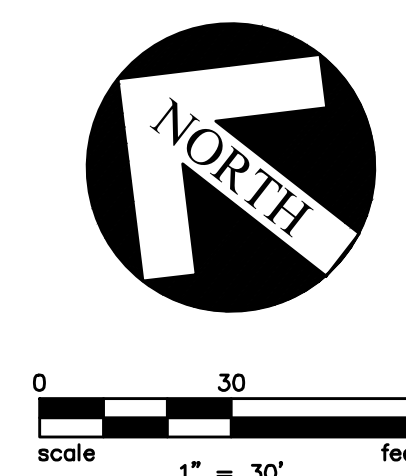

CONSTRUCTION POINTS OF CONTACT:

Kerry Eldredge
Field Superintendent
(916) 202-1381
Keldredge@milestoneconstructiongrp.com

Sriram Kora
Project Manager
(408) 677-6654
Sriram@milestoneconstructiongrp.com

DATE 06-09-2025

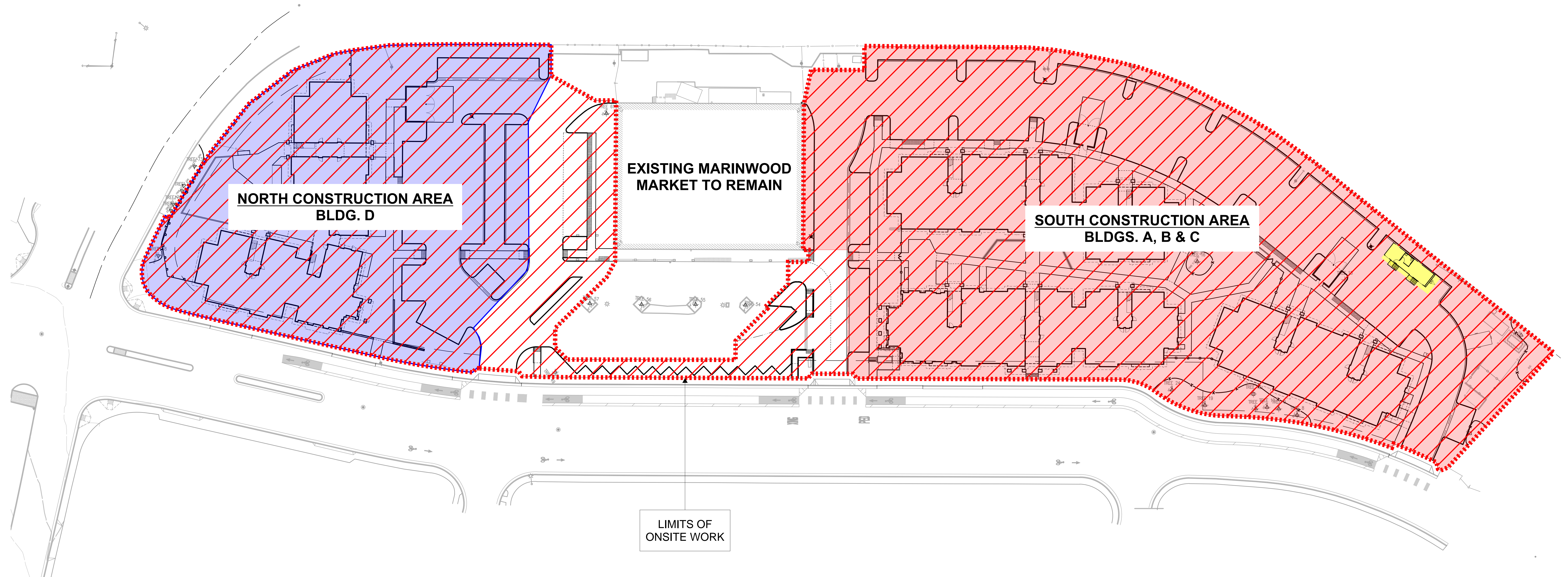

LIMITS OF
ONSITE WORK

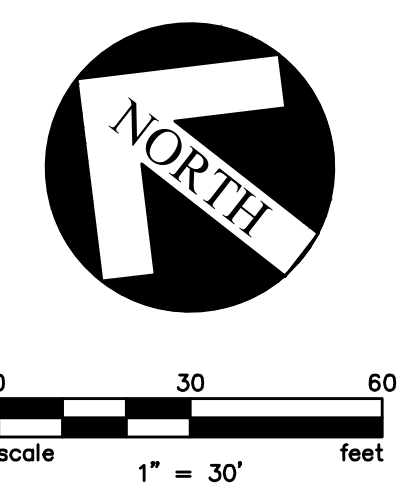

CONSTRUCTION POINTS OF CONTACT:

Kerry Eldredge
Field Superintendent
(916) 202-1381
Keldredge@milestoneconstructiongrp.com

Sriram Kora
Project Manager
(408) 677-6654
Sriram@milestoneconstructiongrp.com